

VOLMARINE

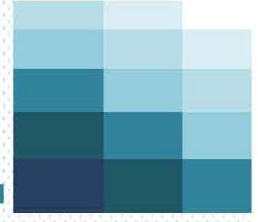

SHIP TECHNOLOGIES

DESIGN-CONSULTANCY-CONSTRUCTION-MACHINERY

NAVAL ARCHITECTURE & MARINE ENGINEERING OFFICE

PRESENTATION BROCHURE & SHIP DESIGN PORTFOLIO

JANUARY 2023

Web : www.vol-marine.com
E-mail : volkan@vol-marine.com
E-mail : info@vol-marine.com
Tel : +90 536 377 32 33
Facebook : Volmarine-Ship-Technologies-Gemi-Dizayn-Ofisi
Adress : VARYAP PLAZA PENDİK
Esenyalı Mahallesi, Uygur Sokak, No:61, Ofis No:74
PENDİK / İSTANBUL / TURKIYE

About Us:

VOLMARINE is a naval architecture & marine engineering company located at Istanbul Turkey. Our main objectives are to design effective and efficient commercial vessels; planning and managing ship building operations within feasible time and quality.

Our Field of Activity:

Ship Design:

- Merchant Ship Design
- Tanker Ship Design
- Passenger Ship Design
- Work Boat Design
- Fishing Vessel Design
- Ship Hull Form Design
- Inclining Experiment Calculations
- Ship Stability Calculations
- Construction Scantling Calculations
- Power-Resistance Predictions
- Class Drawings and Booklet Preparations

Project Management & Planning:

- Commercial Ship Design
- Tanker Ship Design
- Passenger Ship Design
- Work Boat Design
- Fishing Vessel Design
- Ship Hull Form Design
- Inclining Experiment Calculations
- Ship Stability Calculations
- Construction Scantling Calculations
- Power-Resistance Predictions
- Class Drawings and Booklet Preparations

Our Ship Design Capabilities

Various types of ship designs available for efficiency, seakeeping, speed, high capacity & safety, according to the purpose of the vessel. Tanker design, dry cargo ship design, general cargo ship design, container ship design, bulk carrier design, passenger ship design, fishing vessel design, service boat design, workboat design, supply boat design, crew boat design, dinner cruise boat design, etc. according to the objective of customers within engineering principles, ship classification authorities rules, statutory rules, flag state rules & regulations.

In this presentation brochure, you can see some of our sample ship design works.

OUR CERTIFICATES:

2022



UNION OF CHAMBERS OF TURKISH ENGINEERS AND ARCHITECTS
CHAMBER OF NAVAL ARCHITECTS & MARINE ENGINEERS
(GEMİ MÜHENDİSLERİ ODASI)

**REGISTRY DOCUMENT FOR PROFESSIONAL
NAVAL ARCHITECT AND MARINE ENGINEER**

GMO Registry No: 2184

Name:
Mustafa Volkan ESATOĞLU

Professional Naval Architect Registry No
SGM.194

The naval architect that the name is presented above, is authorised under the rules of *TMMOB Chamber of Naval Architects & Marine Engineers as Professional Naval Architect.*

Date Issued : 03.01.2022
Validity : 31.12.2022

TMMOB
CHAMBER OF NAVAL ARCHITECTS & MARINE
ENGINEERS
CHAIRMAN



Form No : FS02.8 Tc: 30.07.2019

2022



UNION OF CHAMBERS OF TURKISH ENGINEERS AND ARCHITECTS
CHAMBER OF NAVAL ARCHITECTS & MARINE ENGINEERS
(GEMİ MÜHENDİSLERİ ODASI)

**PROFESSIONAL DESIGN AND ENGINEERING OFFICE
OFFICE REGISTRATION DOCUMENT**

Name
VOLMARINE Gemi Teknolojileri Müh. Ltd. Şti.

Registry No:
01-174

TESCİLE ESAS SGM'LERİNİN	
Adı, Soyadı	Odun Sicil No.
1- Mustafa Volkan ESATOĞLU	2184

The company that the name of it is presented above is authorised as **Professional Naval Architecture and Marine Engineering Office** under the rules of TMMOB Chamber of Naval Architects and Marine Engineers.

Date Issued : 03.01.2022
Validity : 31.12.2022

TMMOB
CHAMBER OF NAVAL ARCHITECTS & MARINE
ENGINEERS
CHAIRMAN



Form No : FS2.3 Tc: 30.07.2019



TÜRK MÜHENDİS VE MİMAR ODALARI BİRLİĞİ
GEMİ MÜHENDİSLERİ ODASI

KATILIM BELGESİ

Belge No: 48.005

2184 Sicil Numaralı Üyemiz

Sayın

Mustafa Volkan ESATOĞLU

GEMİSEM tarafından düzenlenen

**SERBEST GEMİ MÜHENDİSLİĞİ HİZMETLERİ VE
UYGULAMA ESASLARI**

Meslek İçi Temel Eğitime Katılmıştır.

10 Şubat 2017
Gemi Mühendisleri Odası Genel Merkez
İstanbul

Salih BOSTANCI
GEMİ MÜHENDİSLERİ ODASI
GENEL SEKRETER

Galip GÜNGÖRDÜ
GEMİ MÜHENDİSLERİ ODASI
EĞİTİM EN





TMMOB GEMİ MÜHENDİSLERİ ODASI Anayasanın 135. maddesinde tanımlanmış, 6235 (7503) sayılı ve 28.05.2019 tarihli Bakanlar Kurulu Kararı ile kurulmuş ve faaliyetleri kanunla düzenlenmiştir.

2022



UNION OF CHAMBERS OF TURKISH ENGINEERS AND ARCHITECTS
CHAMBER OF NAVAL ARCHITECTS & MARINE ENGINEERS
(GEMİ MÜHENDİSLERİ ODASI)

**CERTIFICATE
OF ENGINEER CHARTERED FOR SHIP
INSPECTION**

GMO Registry No: 2184

Name
Mustafa Volkan ESATOĞLU

Chartered Engineer Certificate No.
GKYM.86

The Marine Engineer whose name is given above, has been issued the certificate of *Chartered Engineer Authorized for Ship Inspection* in accordance with the provisions of the *Guidelines of the Chamber of Naval Architects & Marine Engineers, TMMOB, Regarding Authorization for Ship Inspection.*

Effective Date : 31.02.2022

TMMOB
CHAMBER OF NAVAL ARCHITECTS & MARINE
ENGINEERS
CHAIRMAN



Form No : FS2.12 Tc: 30.07.2019

15M SUPPLY VESSEL:



DESIGN CONSULTANCY CONSTRUCTION MACHINERY



15m SUPPLY VESSEL

LOA: 15 M
 B: 6 M
 D: 2.8 M
 T: 1.5 M
 TOTAL DISPLACEMENT: 45 TON
 STEEL WEIGHT: 34 TON
 SPEED: 14 KNOT
 POWER: 1x 400 HP

www.vol-marine.com

volkan@vol-marine.com



DESIGN CONSULTANCY CONSTRUCTION MACHINERY



15m SUPPLY VESSEL

LOA: 15 M
 B: 6 M
 D: 2.8 M
 T: 1.5 M
 TOTAL DISPLACEMENT: 45 TON
 STEEL WEIGHT: 34 TON
 SPEED: 14 KNOT
 POWER: 1x 400 HP

www.vol-marine.com

volkan@vol-marine.com

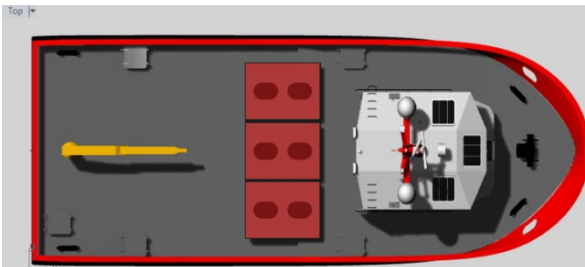

DESIGN CONSULTANCY CONSTRUCTION MACHINERY

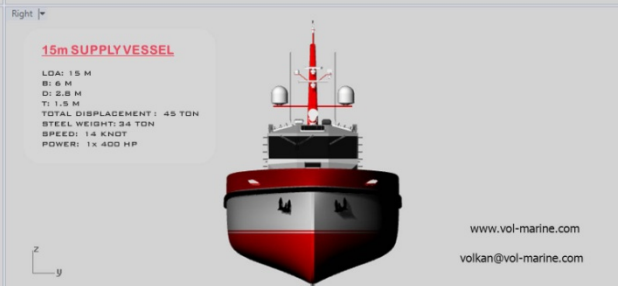

15m SUPPLY VESSEL

LOA: 15 M
 B: 6 M
 D: 2.8 M
 T: 1.5 M
 TOTAL DISPLACEMENT: 45 TON
 STEEL WEIGHT: 34 TON
 SPEED: 14 KNOT
 POWER: 1x 400 HP

www.vol-marine.com

volkan@vol-marine.com

18M SUPPLY VESSEL TYPE-1:

VOLMARINE
SHIP TECHNOLOGIES

DESIGN CONSULTANCY CONSTRUCTION MACHINERY



18m SUPPLY VESSEL

LOA: 18M
B: 8 M
D: 3.5 M
T: 2.1 M
TOTAL DISPLACEMENT: 122 TON
STEEL WEIGHT: 65 TON
SPEED: 14 KNOT
POWER: 1x 700HP

www.vol-marine.com

volkan@vol-marine.com

VOLMARINE
SHIP TECHNOLOGIES

DESIGN CONSULTANCY CONSTRUCTION MACHINERY



18m SUPPLY VESSEL

LOA: 18M
B: 8 M
D: 3.5 M
T: 2.1 M
TOTAL DISPLACEMENT: 122 TON
STEEL WEIGHT: 65 TON
SPEED: 14 KNOT
POWER: 1x 700HP

www.vol-marine.com

volkan@vol-marine.com

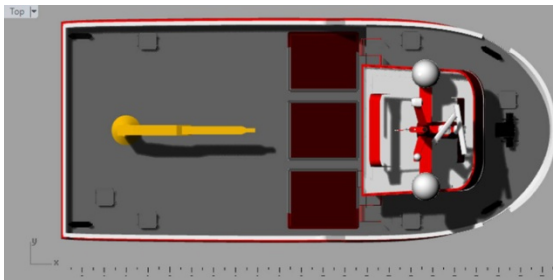

VOLMARINE
SHIP TECHNOLOGIES

DESIGN CONSULTANCY CONSTRUCTION MACHINERY

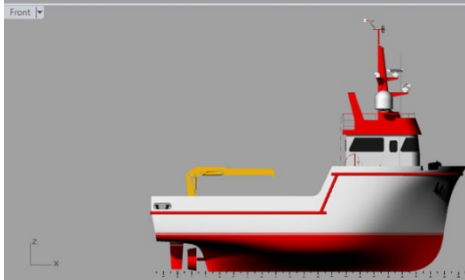

18m SUPPLY VESSEL

LOA: 18M
B: 8 M
D: 3.5 M
T: 2.1 M
TOTAL DISPLACEMENT: 122 TON
STEEL WEIGHT: 65 TON
SPEED: 14 KNOT
POWER: 1x 700HP

www.vol-marine.com
volkan@vol-marine.com

18M SUPPLY VESSEL TYPE-2 (WITH BULB) :



DESIGN CONSULTANCY CONSTRUCTION MACHINERY



**18m SUPPLY VESSEL
VERSION WITH BULB**

LDA: 18M
B: 8 M
D: 3.5 M
T: 2.1 M
TOTAL DISPLACEMENT: 1127 TON
STEEL WEIGHT: 68 TON
SPEED: 14 KNOT
POWER: 1 x 700HP

www.vol-marine.com

volkan@vol-marine.com



DESIGN CONSULTANCY CONSTRUCTION MACHINERY



**18m SUPPLY VESSEL
VERSION WITH BULB**

LDA: 18M
B: 8 M
D: 3.5 M
T: 2.1 M
TOTAL DISPLACEMENT: 1127 TON
STEEL WEIGHT: 68 TON
SPEED: 14 KNOT
POWER: 1 x 700HP

www.vol-marine.com

volkan@vol-marine.com

Top

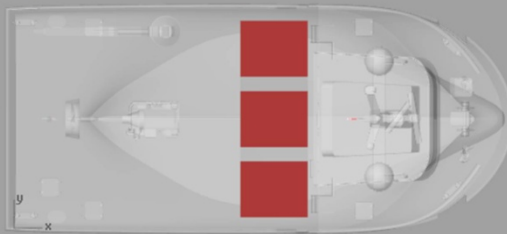

Perspective



DESIGN CONSULTANCY CONSTRUCTION MACHINERY

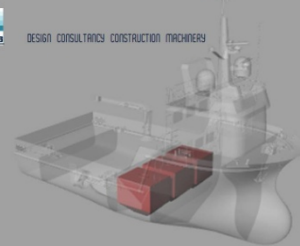

Front

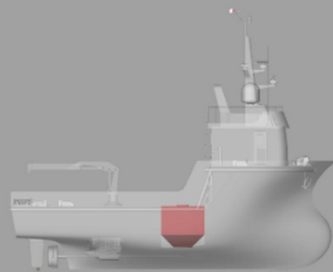

Right

**18m SUPPLY VESSEL
VERSION WITH BULB**

LDA: 18M
B: 8 M
D: 3.5 M
T: 2.1 M
TOTAL DISPLACEMENT: 1127 TON
STEEL WEIGHT: 68 TON
SPEED: 14 KNOT
POWER: 1 x 700HP



www.vol-marine.com

volkan@vol-marine.com

15M FISHING VESSEL PARAMETRIC HULL FORMS:

TYPE-01:

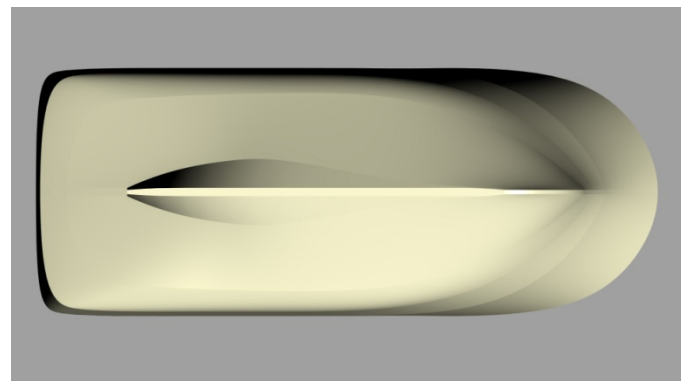
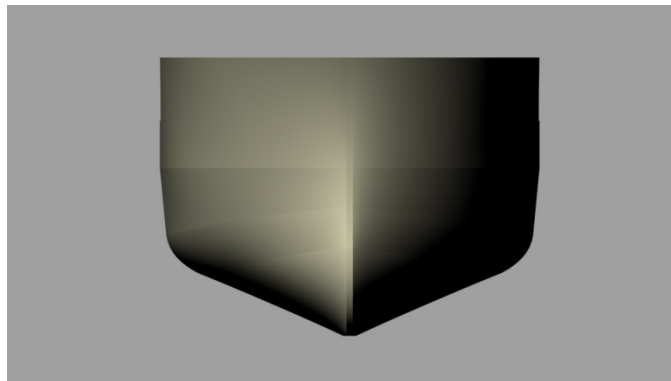
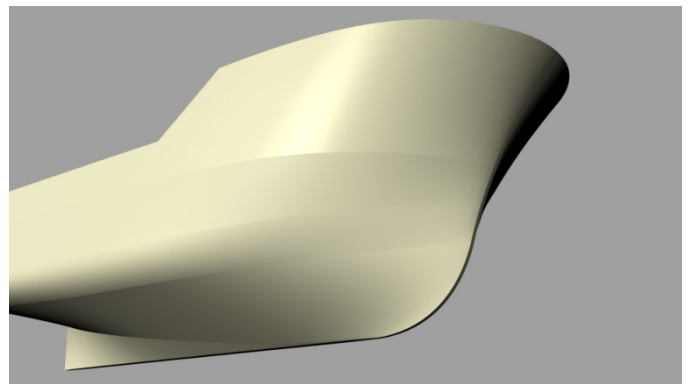
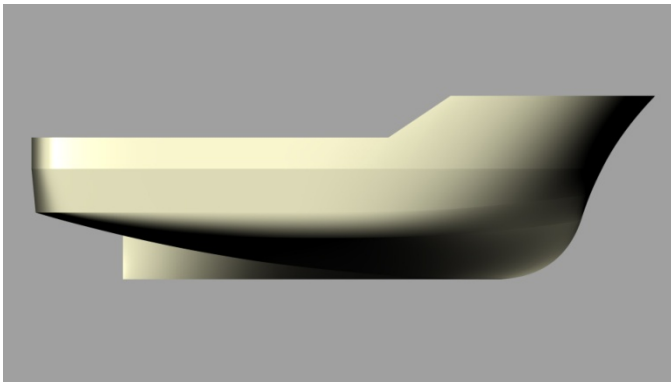

TYPE-02:

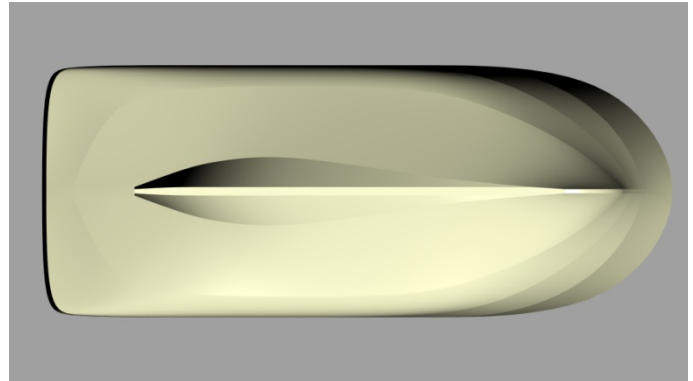
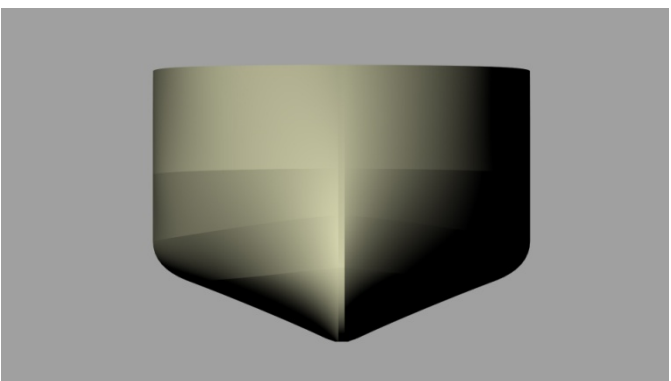
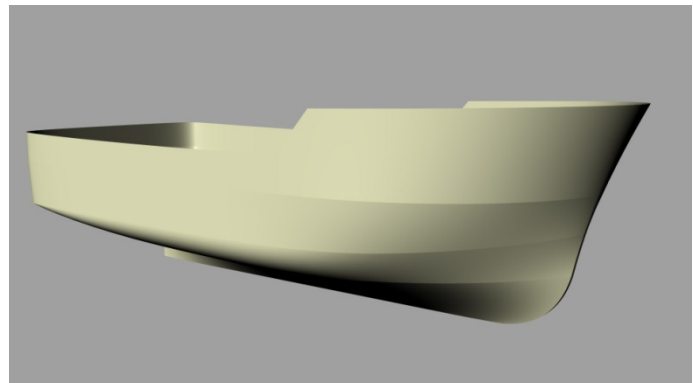
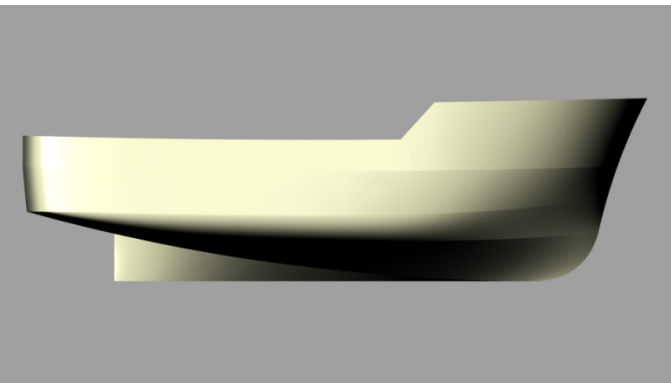

20M FISHING VESSEL

VOLMARINE
SHIP TECHNOLOGIES

DESIGN CONSULTANCY CONSTRUCTION MACHINERY



20m FISHING VESSEL

LDA: 20.4 M
B: 6.50 M
D: 3.10 M
T: 3.10 M
TOTAL DISPLACEMENT: 115 TON
STEEL WEIGHT: 85 TON
SPEED: 11 KNOT
POWER: 1 x 600HP

www.vol-marine.com

volkan@vol-marine.com

VOLMARINE
SHIP TECHNOLOGIES

DESIGN CONSULTANCY CONSTRUCTION MACHINERY



20m FISHING VESSEL

LDA: 20.4 M
B: 6.50 M
D: 3.10 M
T: 3.10 M
TOTAL DISPLACEMENT: 115 TON
STEEL WEIGHT: 85 TON
SPEED: 11 KNOT
POWER: 1 x 600HP

www.vol-marine.com

volkan@vol-marine.com

VOLMARINE
SHIP TECHNOLOGIES

DESIGN CONSULTANCY CONSTRUCTION MACHINERY



20m FISHING VESSEL

LDA: 20.4 M
B: 6.50 M
D: 3.10 M
T: 3.10 M
TOTAL DISPLACEMENT: 115 TON
STEEL WEIGHT: 85 TON
SPEED: 11 KNOT
POWER: 1 x 600HP

www.vol-marine.com

volkan@vol-marine.com

24M CATAMARAN FISH FEEDER SHIP:



DESIGN CONSULTANCY CONSTRUCTION MACHINERY

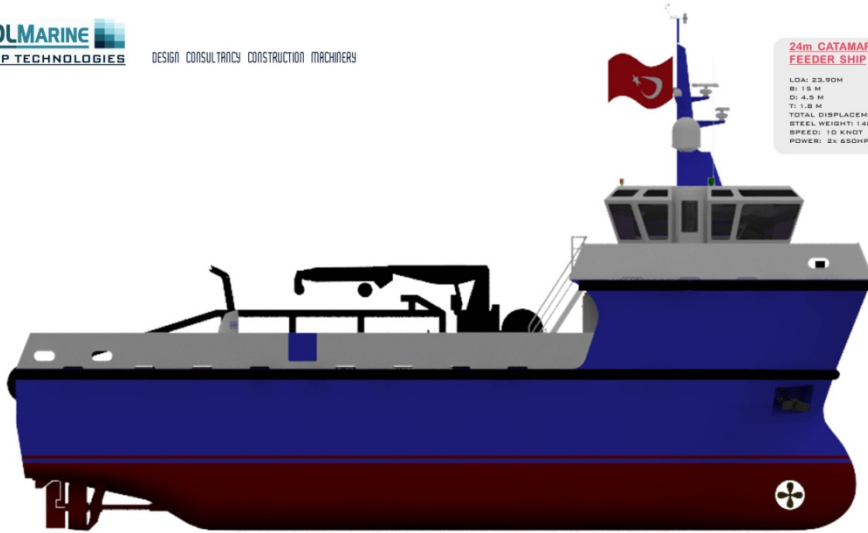

24m CATAMARAN FISH FEEDER SHIP

LOA: 23,90M
B: 15 M
D: 4,5 M
T: 1,8 M
TOTAL DISPLACEMENT: 238TON
STEEL WEIGHT: 140TON
SPEED: 10 KNOT
POWER: 2x 650HP

www.vol-marine.com

volkan@vol-marine.com



DESIGN CONSULTANCY CONSTRUCTION MACHINERY



24m CATAMARAN FISH FEEDER SHIP

LOA: 23,90M
B: 15 M
D: 4,5 M
T: 1,8 M
TOTAL DISPLACEMENT: 238TON
STEEL WEIGHT: 140TON
SPEED: 10 KNOT
POWER: 2x 650HP

www.vol-marine.com

volkan@vol-marine.com



DESIGN CONSULTANCY CONSTRUCTION MACHINERY



24m CATAMARAN FISH FEEDER SHIP

LOA: 23,90M
B: 15 M
D: 4,5 M
T: 1,8 M
TOTAL DISPLACEMENT: 238TON
STEEL WEIGHT: 140TON
SPEED: 10 KNOT
POWER: 2x 650HP

www.vol-marine.com

volkan@vol-marine.com

24M FISHING VESSEL:

VOLMARINE
SHIP TECHNOLOGIES

DESIGN CONSULTANCY CONSTRUCTION MACHINERY

24m FISHING VESSEL

LDAI 23,90 M
B: 8,30 M
D: 3,40 M
TL: 2,30 M
TOTAL DISPLACEMENT: 100 TON
STEEL WEIGHT: 110 TON
SPEED: 13 KNOT
POWER: 11,900 HP



www.vol-marine.com

volkan@vol-marine.com



32M PASSENGER - RESTAURANT BOAT



VOLMARINE
SHIP TECHNOLOGIES

DESIGN CONSULTANCY CONSTRUCTION MACHINERY

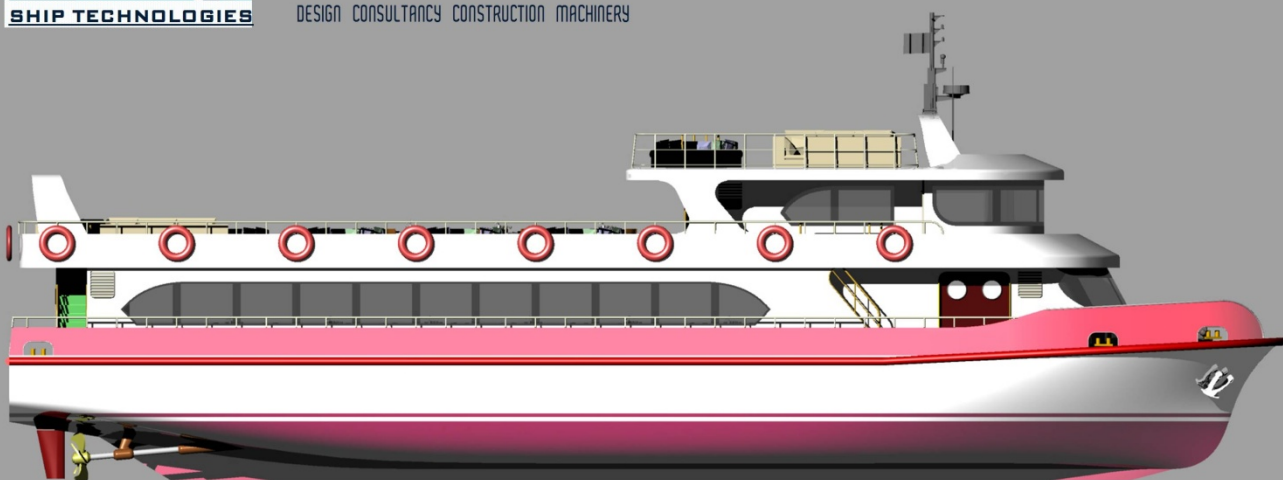

32 M PASSENGER-RESTAURANT SHIP

LOA: 32 M
B: 8 M
D: 2,8M
T: 1,3 M
STEEL WEIGHT: 130 TON
SPEED: 12 KNOT
POWER: 2x 400HP

33M PASSENGER - RESTAURANT BOAT



DESIGN CONSULTANCY CONSTRUCTION MACHINERY

33 M PASSENGER-RESTAURANT SHIP

LOA: 33 M
B: 8 M
D: 2.7M
T: 1.3 M
STEEL WEIGHT: 135 TON
SPEED: 12 KNOT
POWER: 2x 400HP

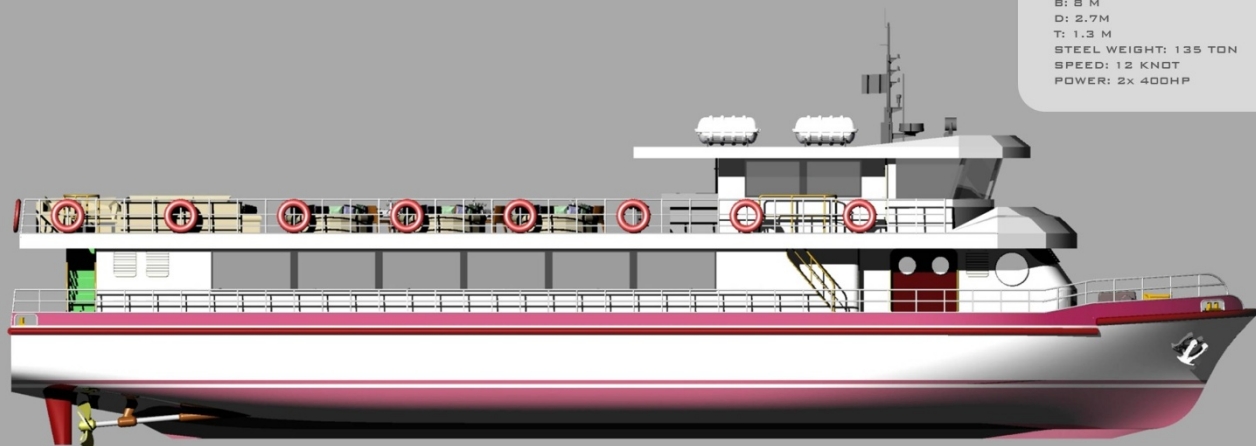

www.vol-marine.com volkan@vol-marine.com



DESIGN CONSULTANCY CONSTRUCTION MACHINERY

www.vol-marine.com volkan@vol-marine.com



33 M PASSENGER-RESTAURANT SHIP

LOA: 33 M
B: 8 M
D: 2.7M
T: 1.3 M
STEEL WEIGHT: 135 TON
SPEED: 12 KNOT
POWER: 2x 400HP



DESIGN CONSULTANCY CONSTRUCTION MACHINERY

33 M PASSENGER-RESTAURANT SHIP

LOA: 33 M
B: 8 M
D: 2.7M
T: 1.3 M
STEEL WEIGHT: 135 TON
SPEED: 12 KNOT
POWER: 2x 400HP

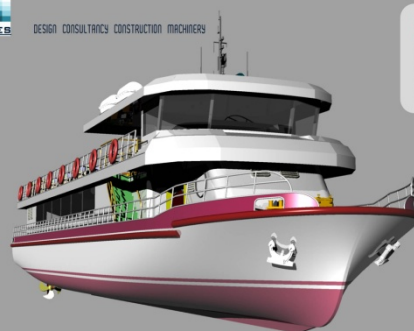

www.vol-marine.com volkan@vol-marine.com

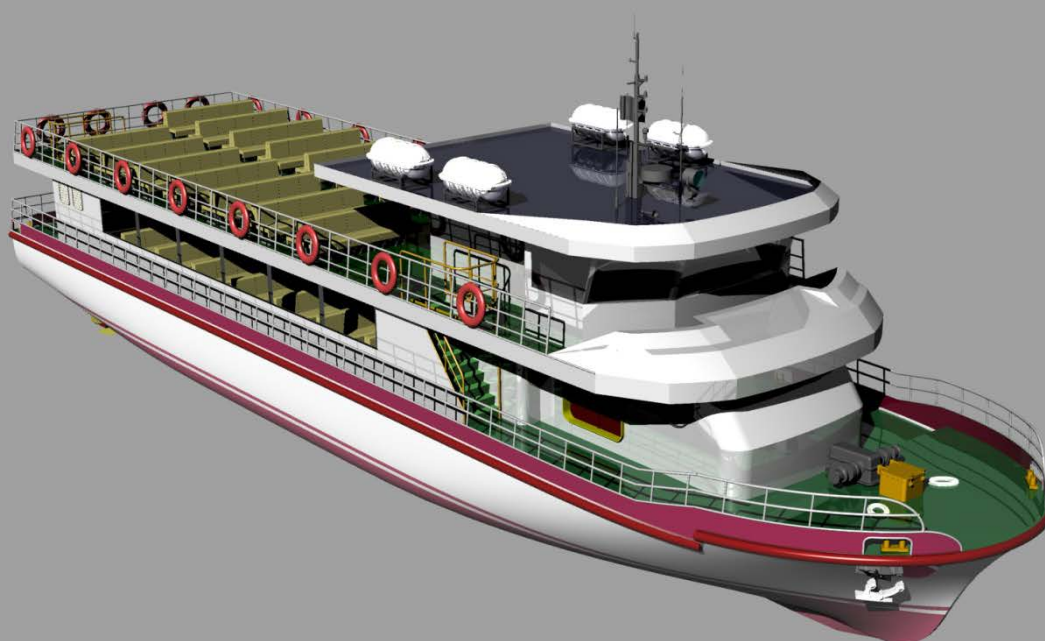

42M CATAMARAN HIGH SPEED PASSENGER CRAFT

VOLMARINE
SHIP TECHNOLOGIES

DESIGN CONSULTANCY CONSTRUCTION MACHINERY

42m CATAMARTAN
PASSENGER SHIP

LOA: 42 M
B: 12 M
D: 4,00 M
T: 1,5 M
TOTAL DISPLACEMENT: 1000 TON

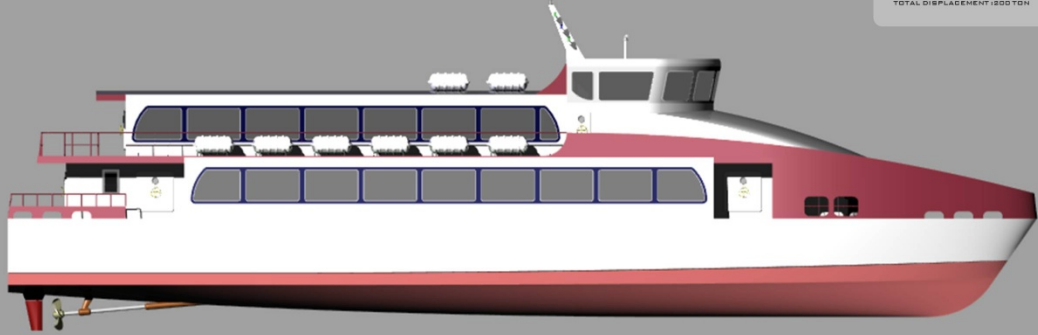

www.vol-marine.com

volkan@vol-marine.com

VOLMARINE
SHIP TECHNOLOGIES

DESIGN CONSULTANCY CONSTRUCTION MACHINERY

42m CATAMARTAN
PASSENGER SHIP

LOA: 42 M
B: 12 M
D: 4,00 M
T: 1,5 M
TOTAL DISPLACEMENT: 1000 TON



www.vol-marine.com

volkan@vol-marine.com

VOLMARINE
SHIP TECHNOLOGIES

DESIGN CONSULTANCY CONSTRUCTION MACHINERY

42m CATAMARTAN
PASSENGER SHIP

LOA: 42 M
B: 12 M
D: 4,00 M
T: 1,5 M
TOTAL DISPLACEMENT: 1000 TON

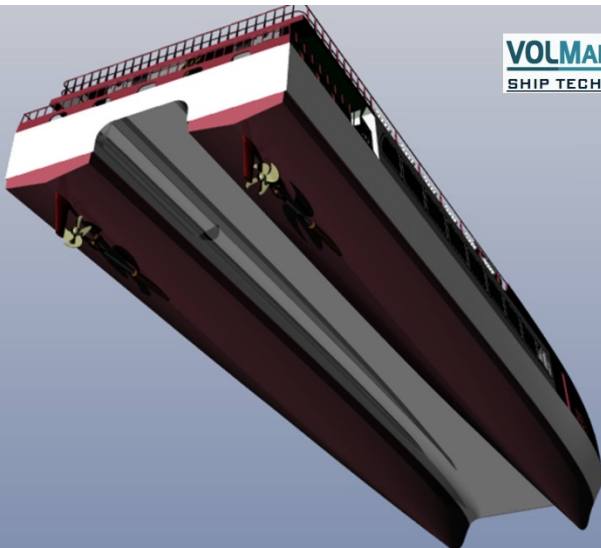

www.vol-marine.com

volkan@vol-marine.com

30M CATAMARAN HIGH SPEED CRAFT - CREW BOAT

VOLMARINE
SHIP TECHNOLOGIES

DESIGN CONSULTANCY CONSTRUCTION MACHINERY

30 M CATAMARAN PASSENGER SHIP

LOA : 30 M
B : 10 M
D : 3.5 M
T : 1.5 M
HULL : ALUMINIUM
SUPERSTRUCTURE:ALUMINIUM
SPEED : 25 KNOT
POWER : 2x 1200 HP
PASSENGER : 172 PAX



www.vol-marine.com

volkan@vol-marine.com



30M CATAMARAN HSC GENERAL ARRANGEMENT PLAN

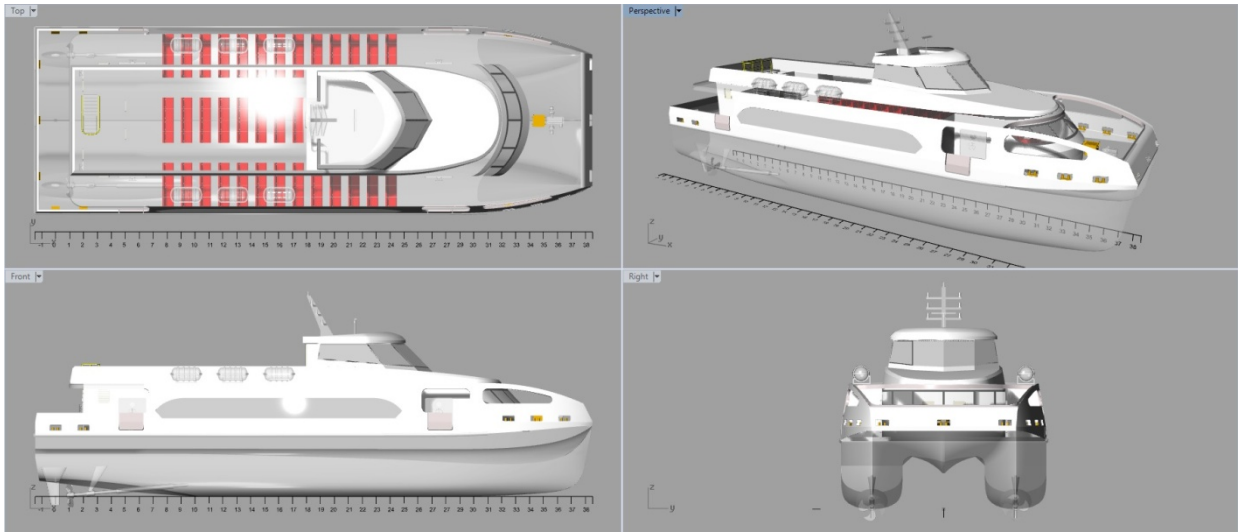

HIGH SPEED CATAMARAN PASSENGER FERRY / CREW BOAT GENERAL ARRANGEMENT PLAN

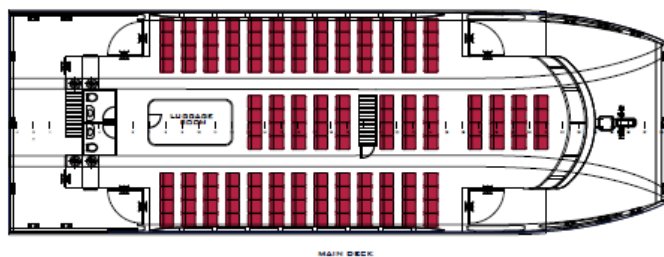
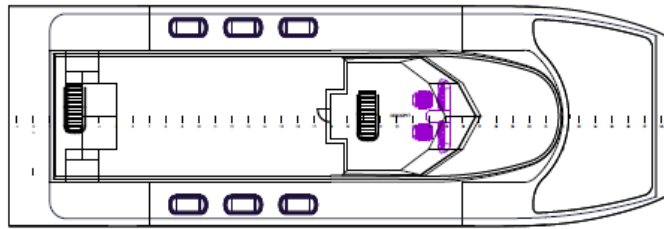
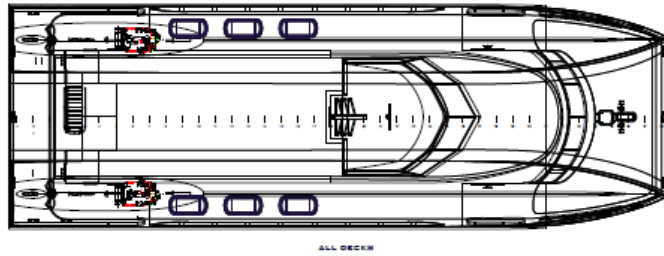
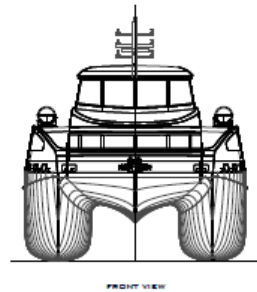
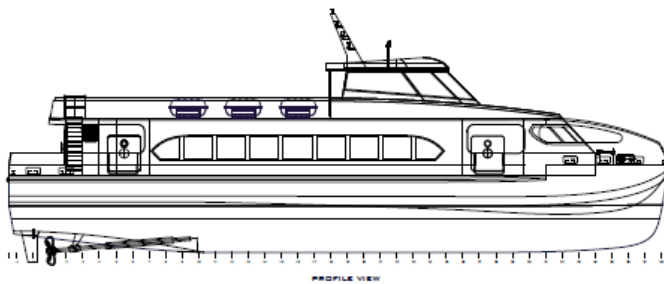
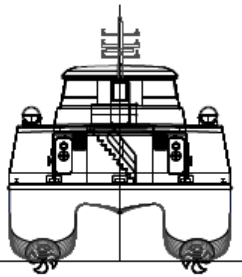

MAIN PARTICULARS:

Length Over All (LOA) : 30.00 m
 Breadth Moulded (B) : 10.00 m
 Depth Moulded (D) : 3.50 m
 Draught Moulded (T) : 1.40 m
 FRAME SPACING : 750 mm

HULL MATERIAL:

MAIN HULL : ALUMINIUM
 SUPER STRUCTURE : ALUMINIUM
 NET METAL WEIGHT : 52 TON

SPEED- POWER:

SERVICE SPEED: 20 KNOT
 MAX SPEED : 23 KNOT +
 MAIN PROPULSION POWER : 2x1200 BHP DIESEL ENGINE

PASSENGER & CREW CAPACITY:

152 PASSENGERS WITH LUGGAGE ROOM
 188 PASSENGERS WITHOUT LUGGAGE ROOM
 4 CREWS

TANK CAPACITY:

FUEL 6 TON
 FRESH WATER : 1 TON
 SEWAGE 1 TON
 BILGE 0.5 TON

PROJECT NAME		HIGH SPEED CATAMARAN PASSENGER FERRY / CREW BOAT	
GENERAL ARRANGEMENT PLAN			
DRAWN BY		DATE	
CHECKED BY		DATE	
APPROVED BY		DATE	
PROJECT NO.		SCALE	
SHEET NO.		TOTAL SHEETS	
DESIGNER		DATE	
DRAWN		DATE	
CHECKED		DATE	
APPROVED		DATE	
PROJECT NO.		SCALE	
SHEET NO.		TOTAL SHEETS	
DESIGNER		DATE	
DRAWN		DATE	
CHECKED		DATE	
APPROVED		DATE	

VOLMARINE
 SHIP TECHNOLOGIES
 DESIGN CONSULTING CONSTRUCTION MANAGEMENT

web: www.vol-marine.com
 e-mail: volmar@vol-marine.com

12M * 2.5M BARGE



DESIGN CONSULTANCY CONSTRUCTION MACHINERY

12m BARGE

LOA: 12 M
 BI: 2.5 M
 DI: 1.8 M
 TI: 0.6 M
 TOTAL DISPLACEMENT: 118.5 TON
 STEEL WEIGHT: 9.4 TON

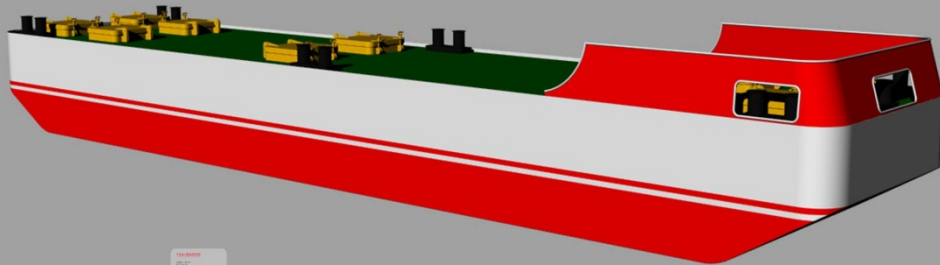

VOLMARINE SHIP TECHNOLOGIES



12m BARGE

volkan@vol-marine.com



DESIGN CONSULTANCY CONSTRUCTION MACHINERY

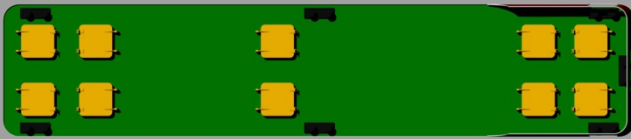

12m BARGE

LOA: 12 M
 BI: 2.5 M
 DI: 1.8 M
 TI: 0.6 M
 TOTAL DISPLACEMENT: 118.5 TON
 STEEL WEIGHT: 9.4 TON

www.vol-marine.com

volkan@vol-marine.com



DESIGN CONSULTANCY CONSTRUCTION MACHINERY



12m BARGE

LOA: 12 M
 BI: 2.5 M
 DI: 1.8 M
 TI: 0.6 M
 TOTAL DISPLACEMENT: 118.5 TON
 STEEL WEIGHT: 9.4 TON

www.vol-marine.com

volkan@vol-marine.com



DESIGN CONSULTANCY CONSTRUCTION MACHINERY

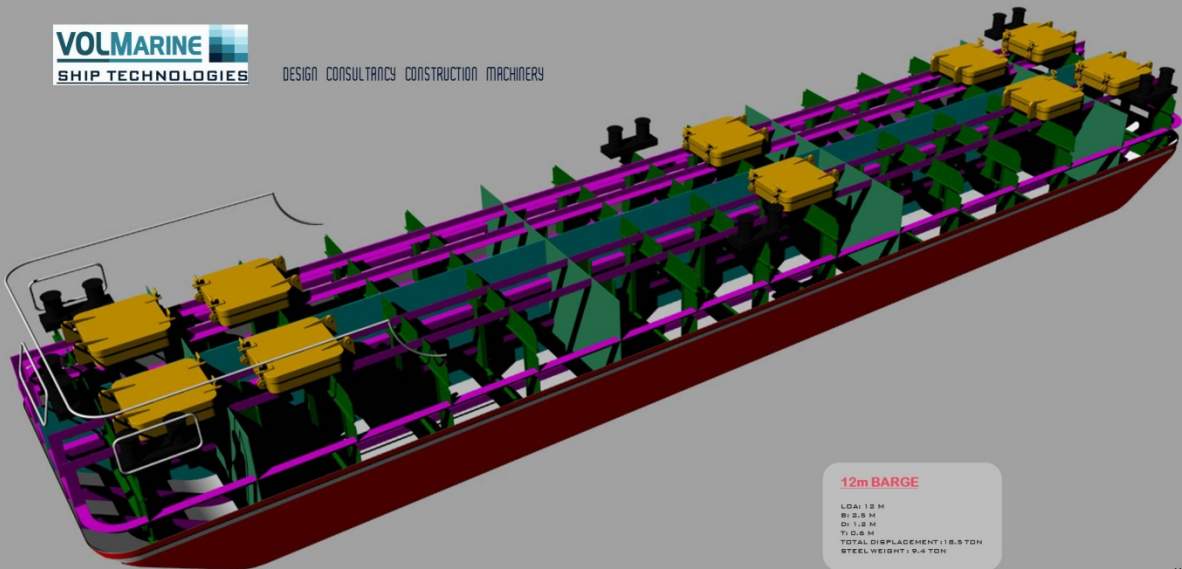

12m BARGE

LOA: 12 M
 BI: 2.5 M
 DI: 1.8 M
 TI: 0.6 M
 TOTAL DISPLACEMENT: 118.5 TON
 STEEL WEIGHT: 9.4 TON

www.vol-marine.com

volkan@vol-marine.com

32M WORKBOAT

VOLMARINE
SHIP TECHNOLOGIES

DESIGN CONSULTANCY CONSTRUCTION MACHINERY

32M BUOY LAYING VESSEL

LDA: 32 M
SB: 24
D: 2.8 M
T: 1.8 M
STEEL WEIGHT: 135 TON
SERVICE SPEED: 10 KNOT
POWER: 2x 470 HP



www.vol-marine.com

volkan@vol-marine.com



32M WORKBOAT GENERAL ARRANGEMENT PLAN



32M BUOY LAYING SHIP GENERAL ARRANGEMENT PLAN

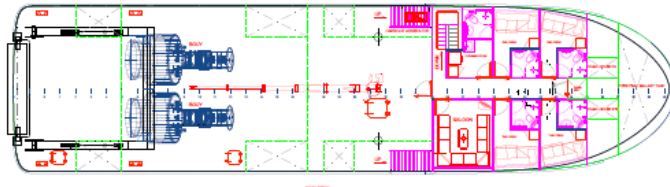
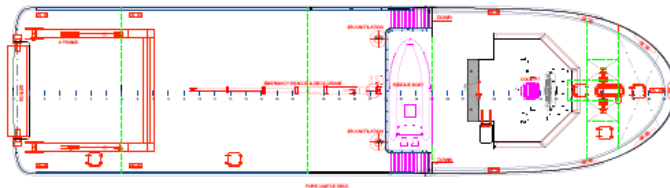
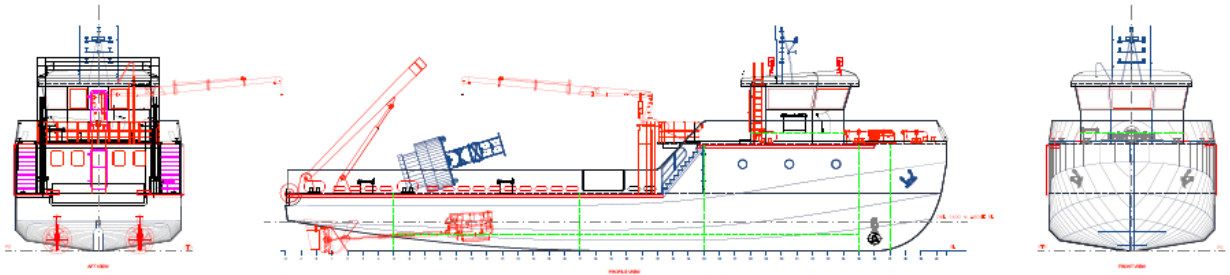

MAIN PARTICULARS:
 Length Over All (LOA) : 32.00 m
 Breath Moulded (B) : 8.00 m
 Depth Moulded (D) : 2.80 m
 Draught Moulded (T) : 1.40 m
 FRAME SPACING : 750 mm
 TOTAL DISPLACEMENT : 198 TON

HULL MATERIAL:
 MAIN HULL : STEEL
 SUPER STRUCTURE : STEEL

SPEED- POWER:
 SERVICE SPEED: 10 KNOT
 MAX SPEED : 12 KNOT +
 MAIN PROPULSION POWER : 2x950 KW DIESEL ENGINE

CREW CAPACITY:
 8 CREWS

TANK CAPACITY:
 DIESEL OIL: 14 TON
 FRESH WATER : 7.5 TON
 BLACK & GREY WATER 3 TON
 BILGE 1.2 TON

NO.	REV.	DATE	DESCRIPTION
BUOY LAYING SHIP			
GENERAL ARRANGEMENT PLAN			
Client	SALASAS SHIPYARD-TURKEY		
Project	SALASAS SHIPYARD		
Scale			
SHIP TECHNOLOGIES DESIGN CONSULTANCY CONSTRUCTION AND REPAIR			
web: www.volmarine.com e-mail: volmar@volmarine.com			
Drawn by	Checked by	Approved by	
Date	Date	Date	
20.02.2021	20.02.2021	20.02.2021	

1000M3 CAPACITY 66M SPLIT BARGE

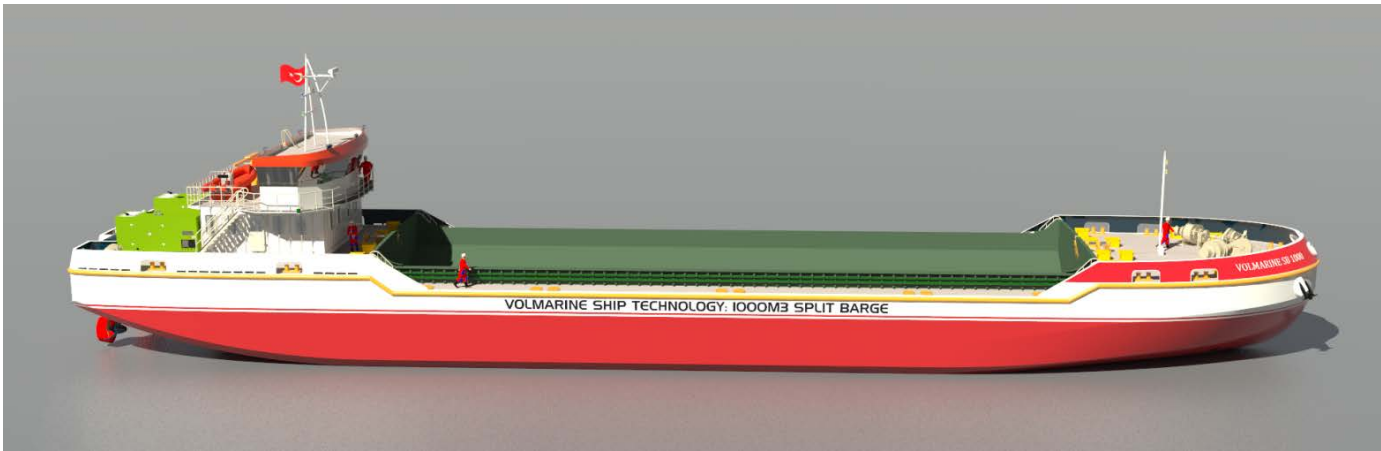

42M *9M PASSENGER BOAT CLASSIC STYLE

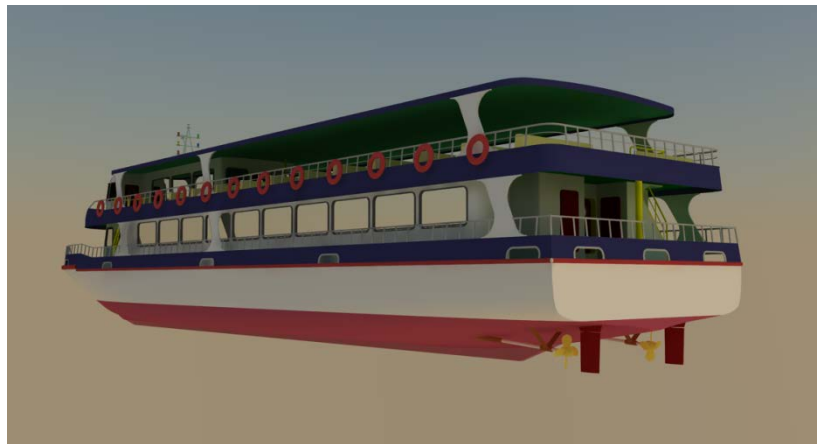
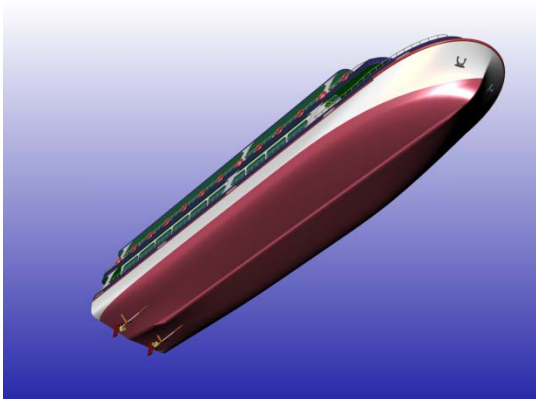
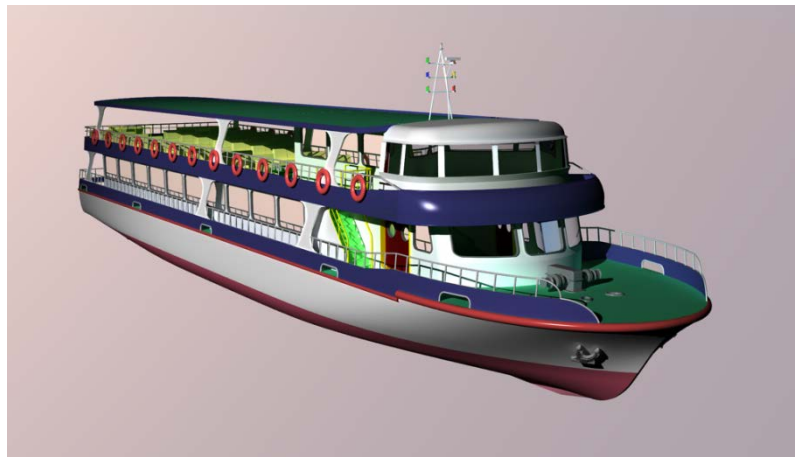
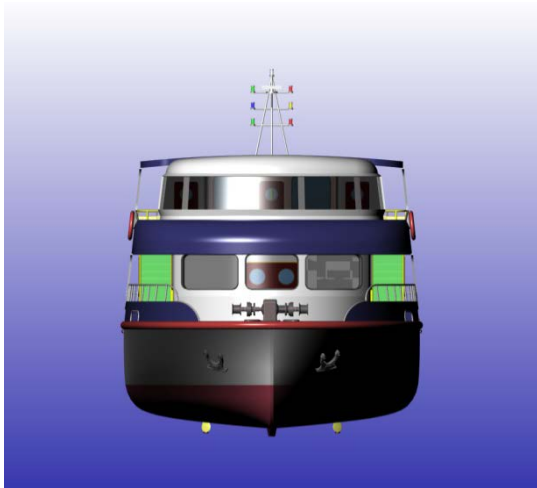

42M *9M PASSENGER BOAT ANTIQUE STYLE

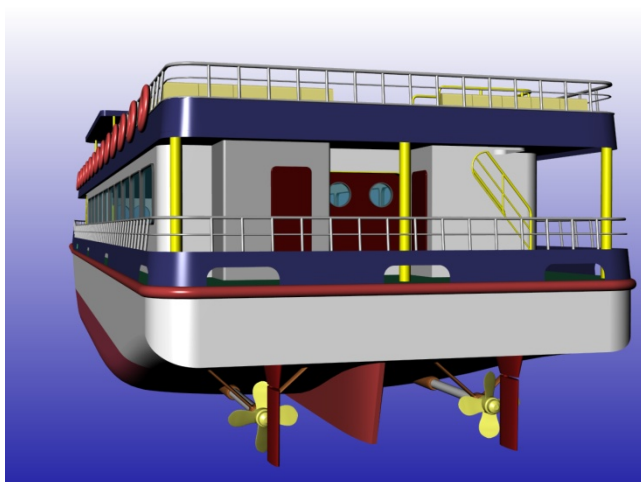
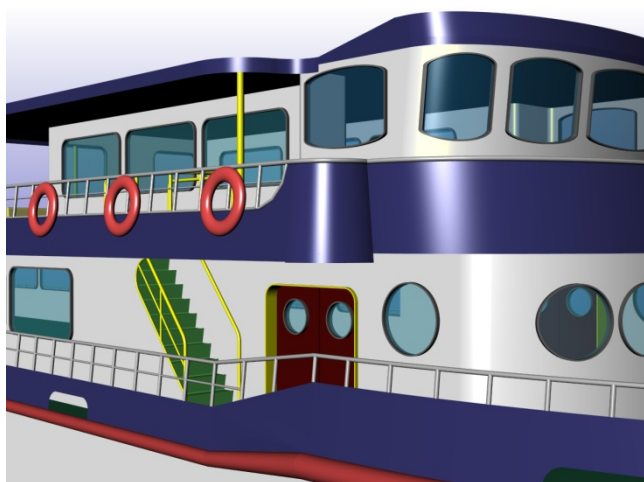
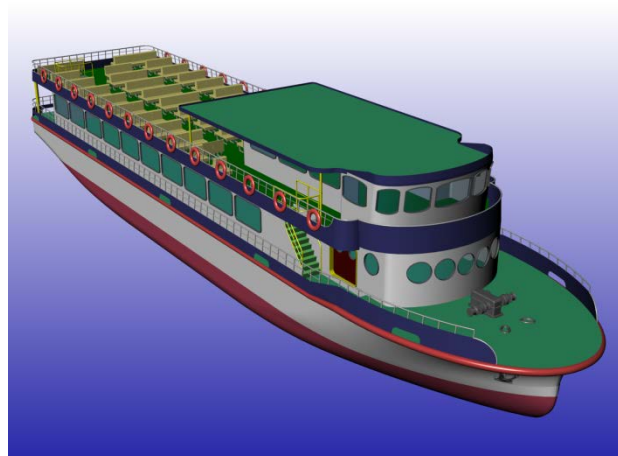
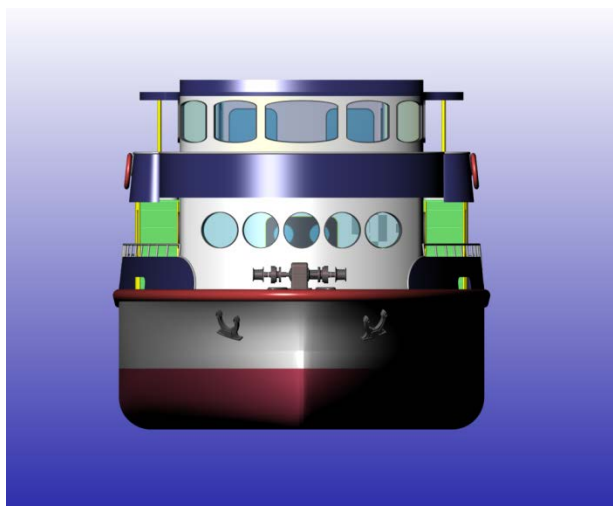
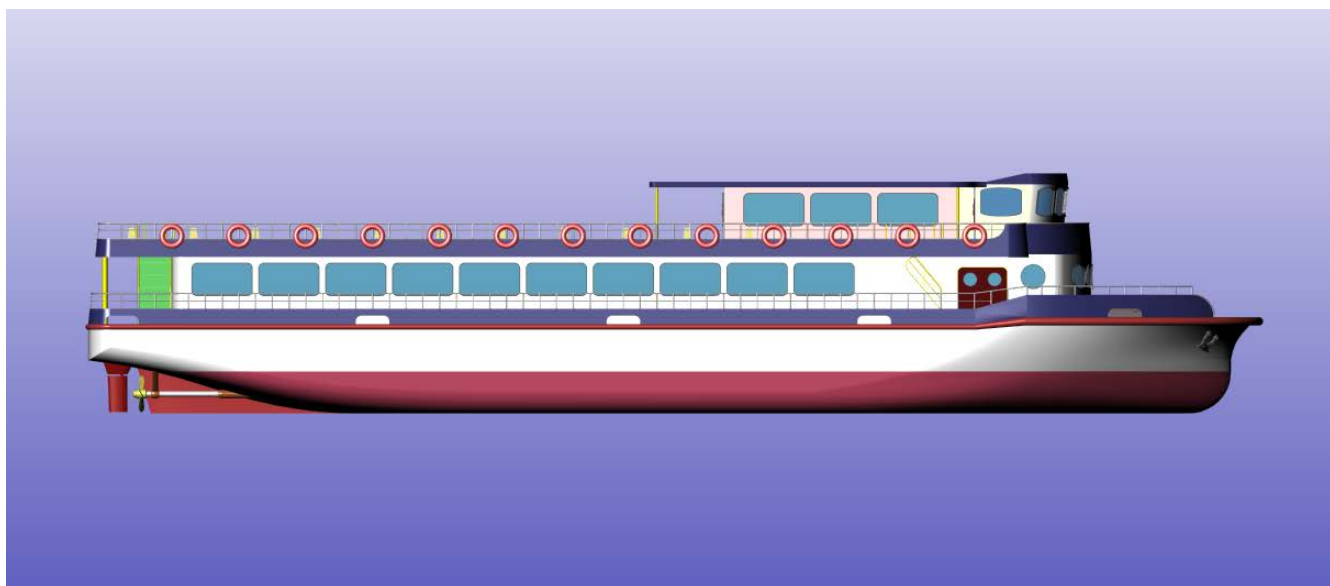

42M *11M PASSENGER BOAT DOUBLE CHINE HULL CONCEPT

VOLMARINE
SHIP TECHNOLOGIES

DESIGN CONSULTANCY CONSTRUCTION MACHINERY

**42m PASSENGER SHIP
DOUBLE CHINE HULL CONCEPT**

LDA: 42 M
B: 11 M
D: 3.5 M
T: 1.55 M
STEEL WEIGHT: 275 TON
SPEED: 13 KNOT
POWER: 2x 750 HP

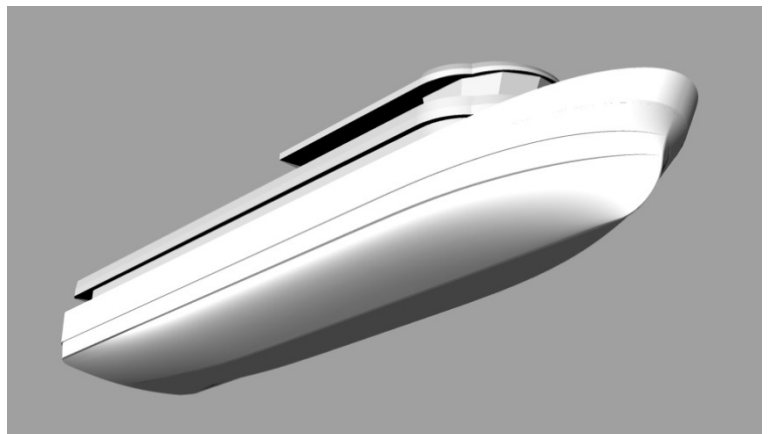
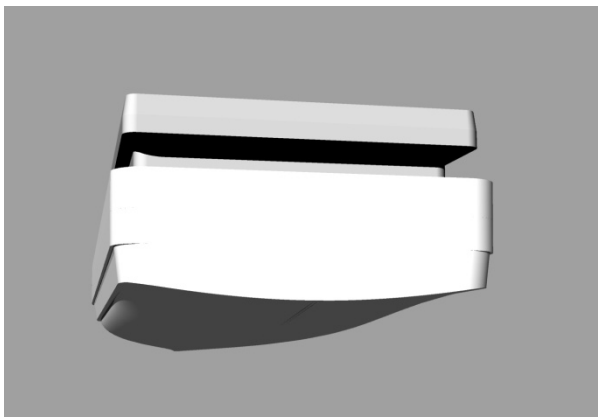
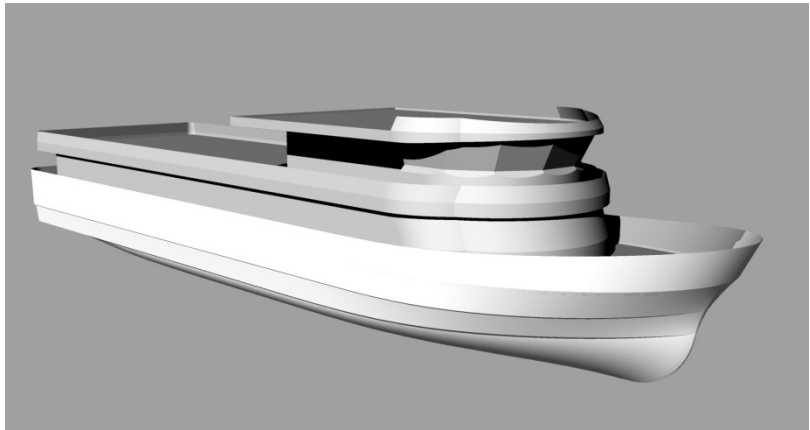
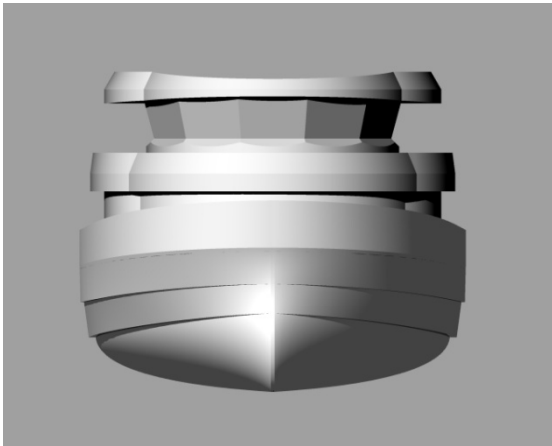
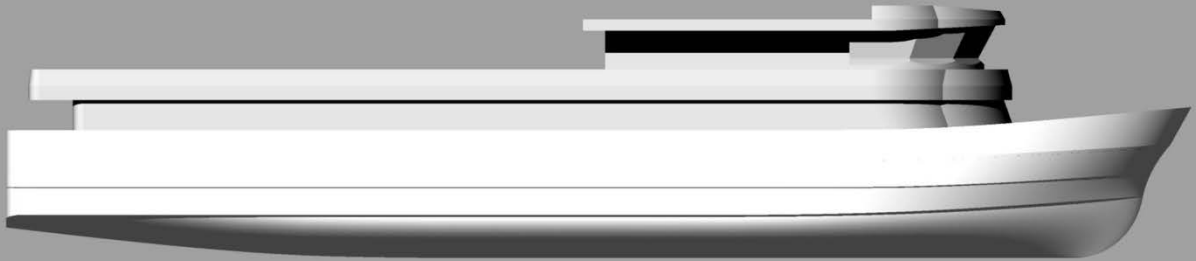

7000 DWT OIL TANKER HULL DESIGN AND GA PLAN

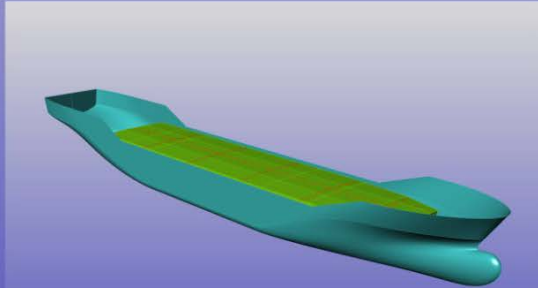

7000 DWT OIL TANKER GENERAL ARRANGEMENT PLAN

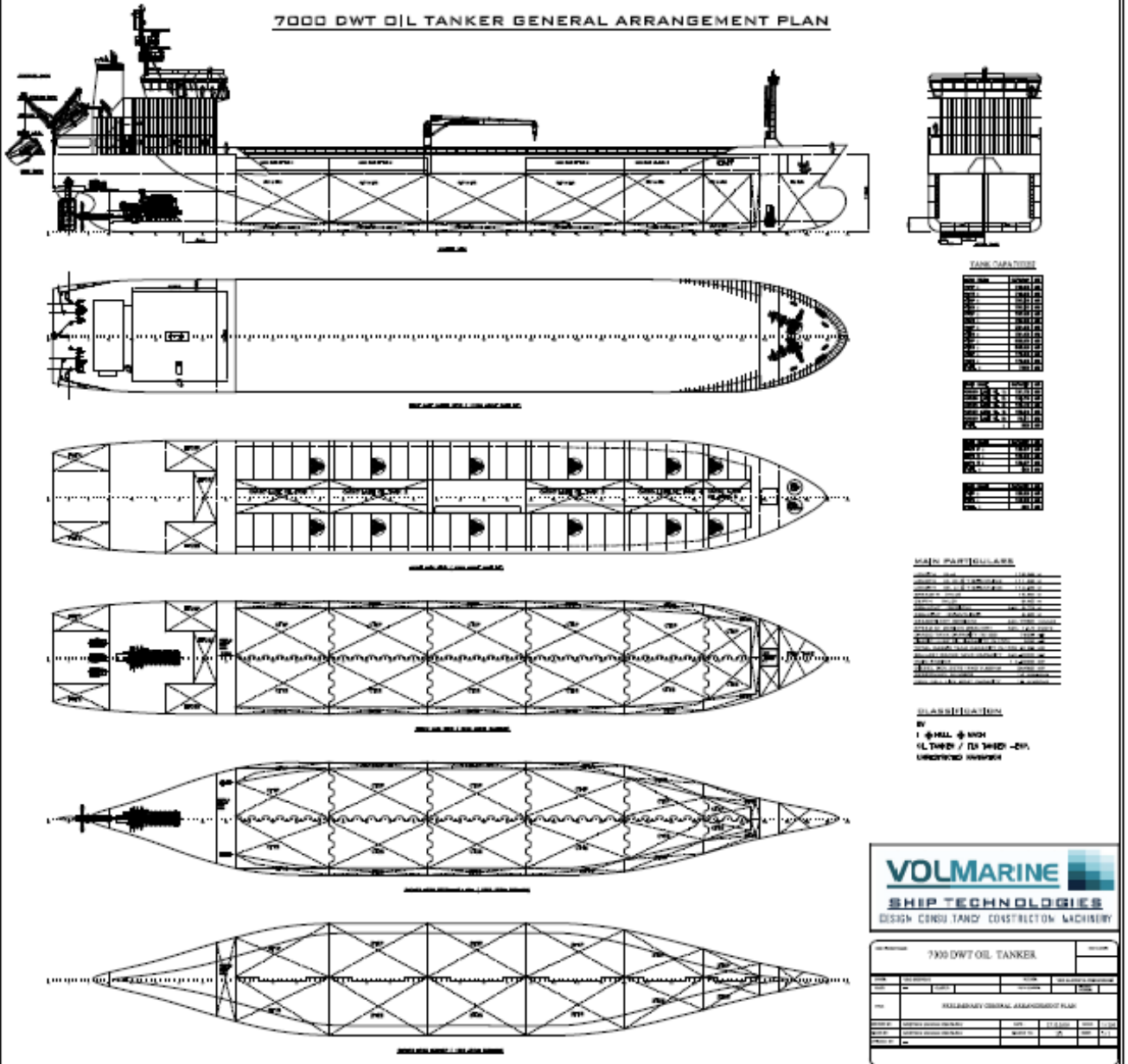

VOLMARINE
 SHIP TECHNOLOGIES
 DESIGN CONSTRUCTION & MAINTENANCE

7000 DWT OIL TANKER

REGULATORY GENERAL ARRANGEMENT PLAN

NO.	DATE	BY	CHECKED	APPROVED
1	2023-10-27	J. SMITH	M. JONES	D. BROWN

6.5M * 2.5M ALUMINIUM CATAMARAN ANTI POLLUTION BOAT

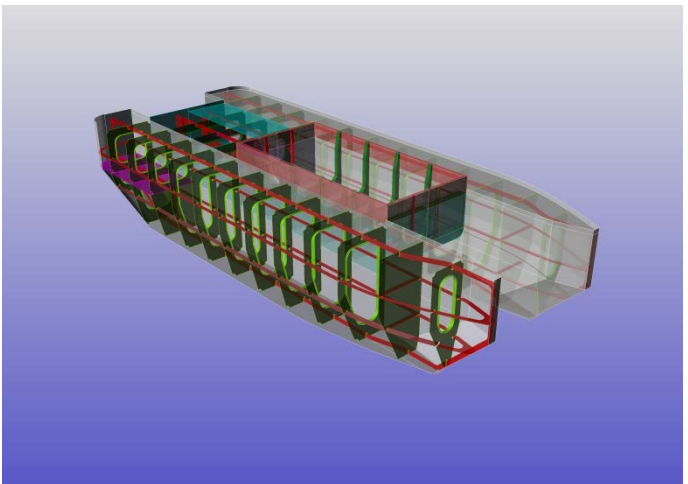
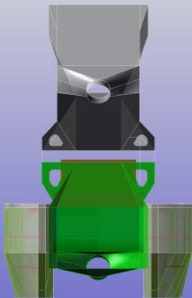
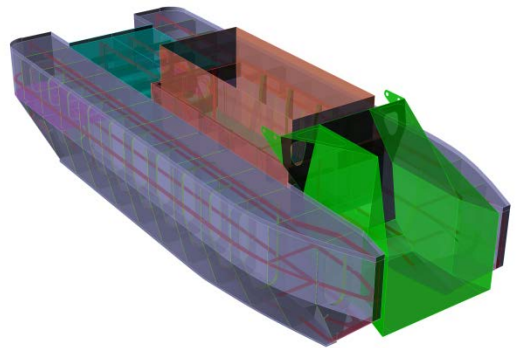
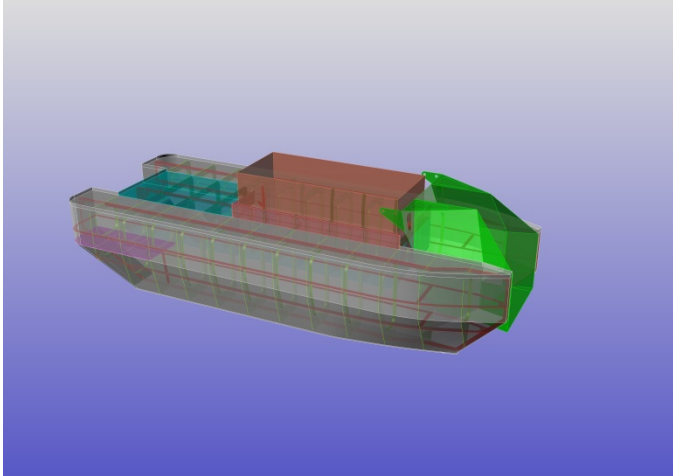
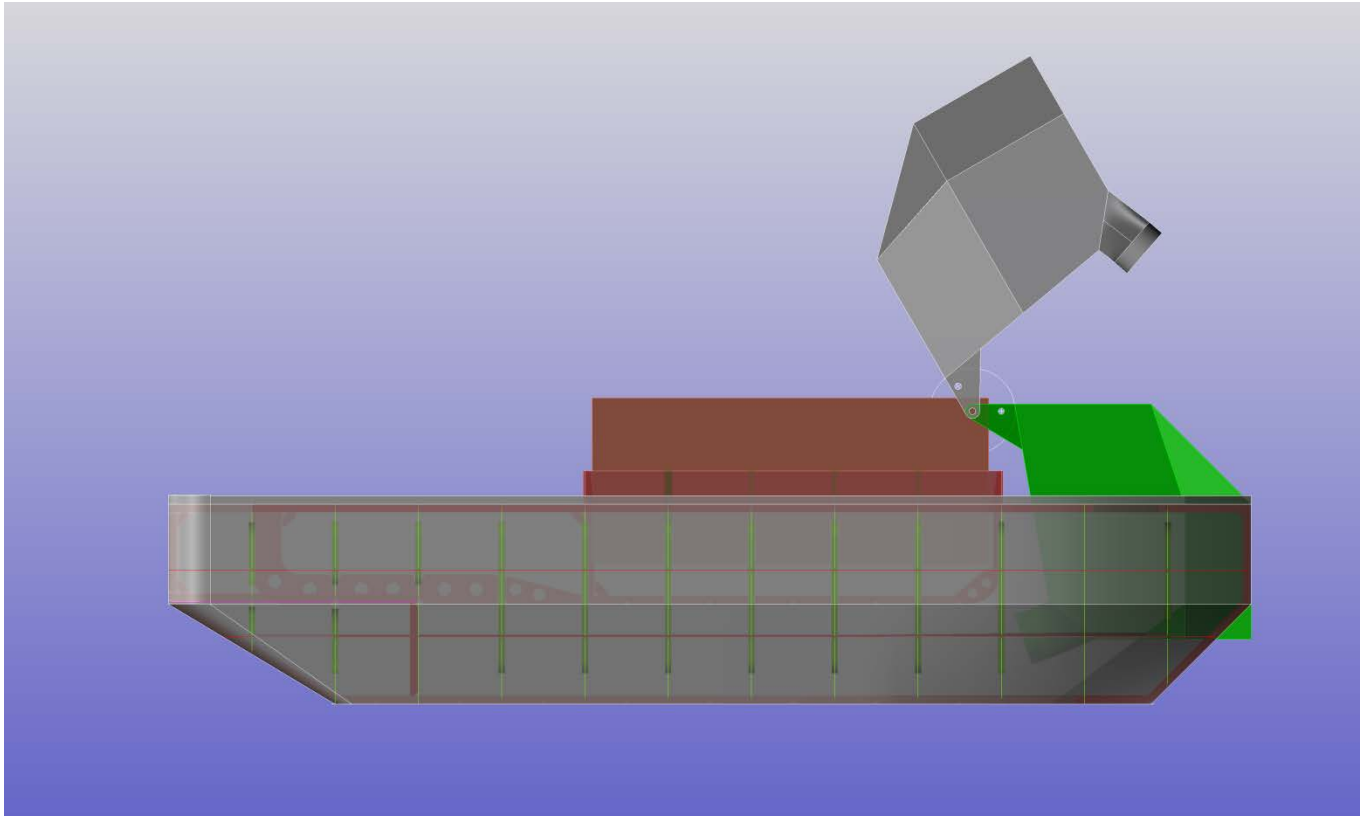

36M 3600M3/H FIRE FIGHTING & RESCUE BOAT

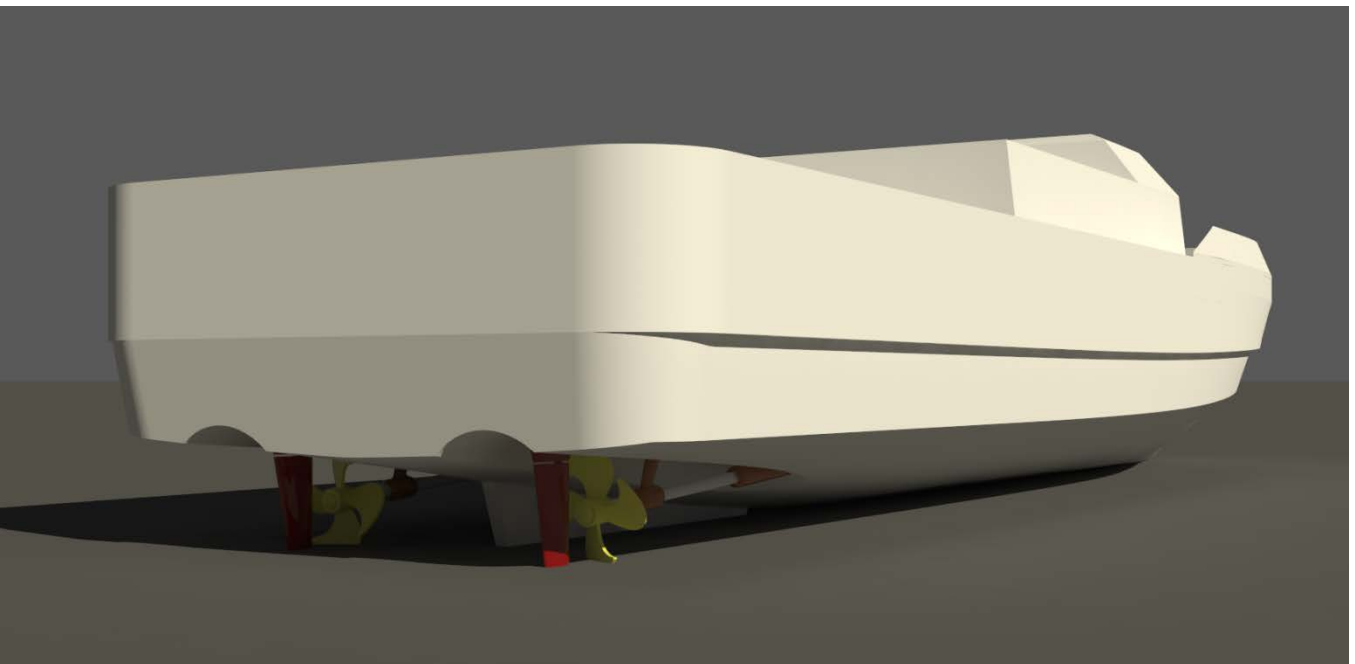
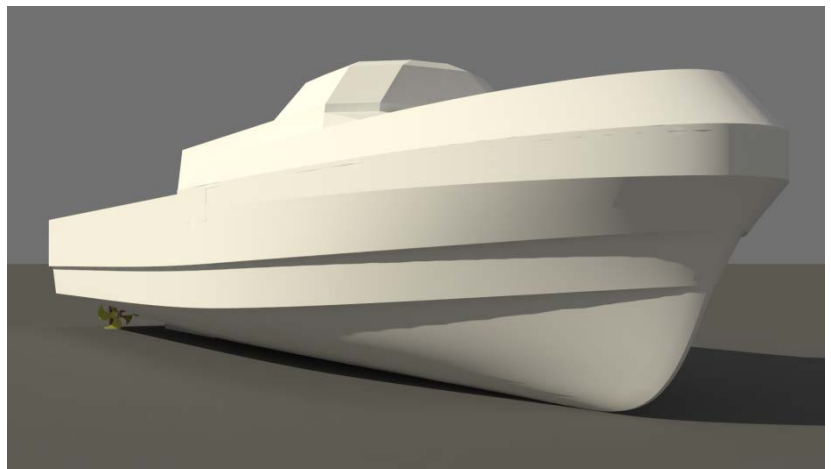
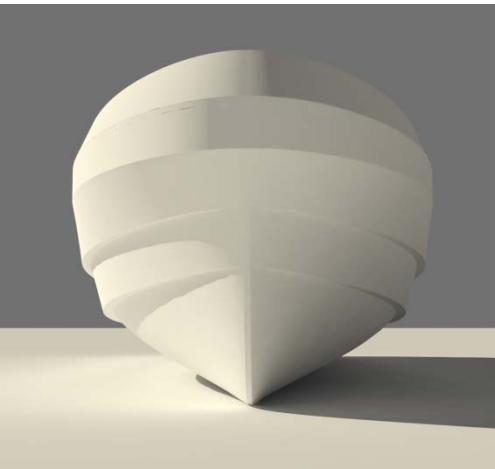
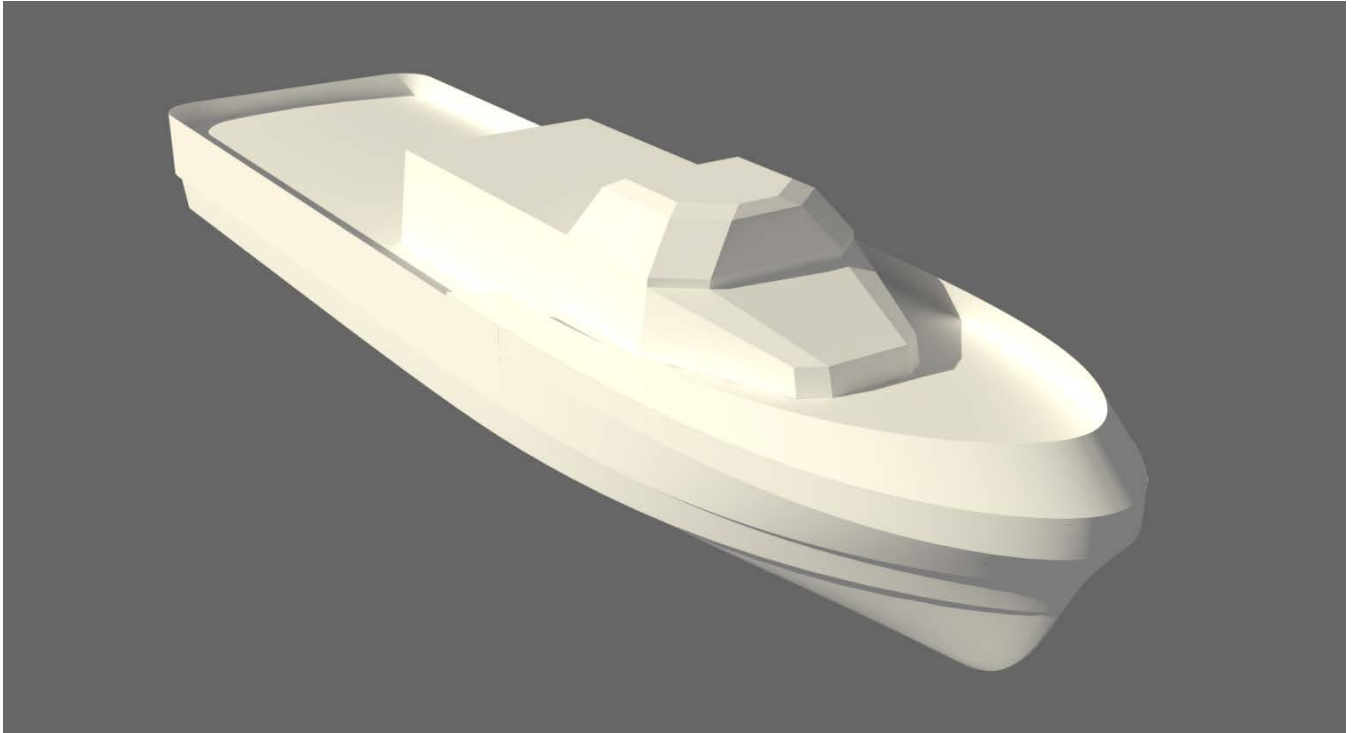

36M 3600M3/H FIRE FIGHTING & RESCUE BOAT GA PLAN

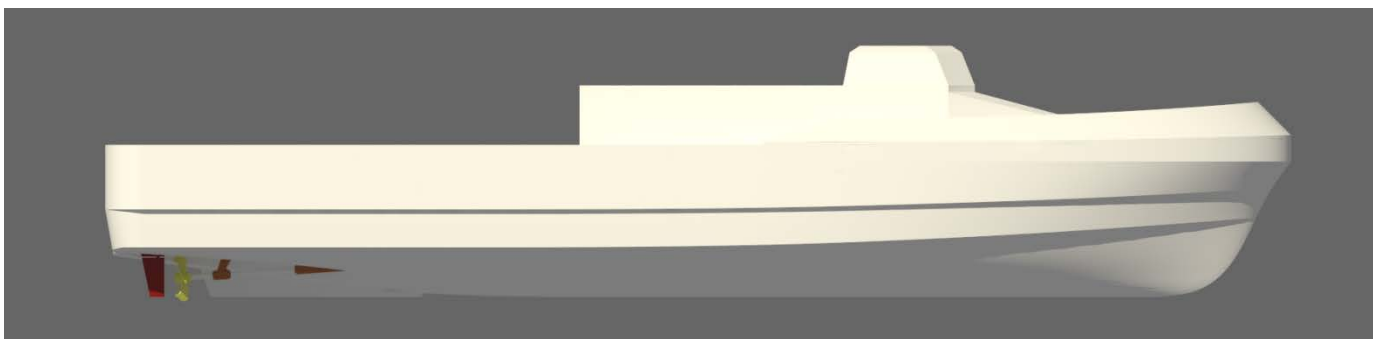

36M 3600 M3/H CAPACITY FIRE FIGHTING BOAT GENERAL ARRANGEMENT PLAN

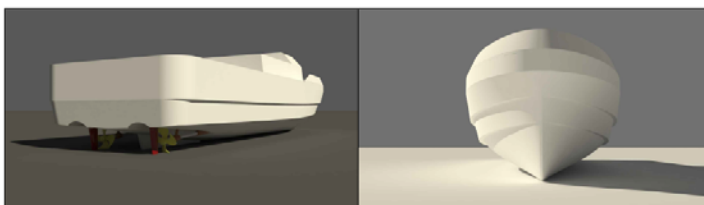
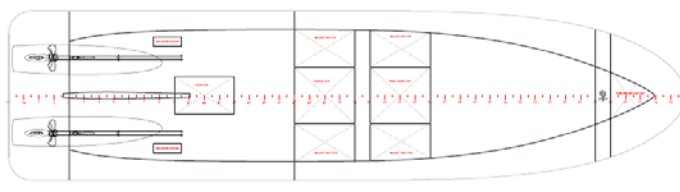
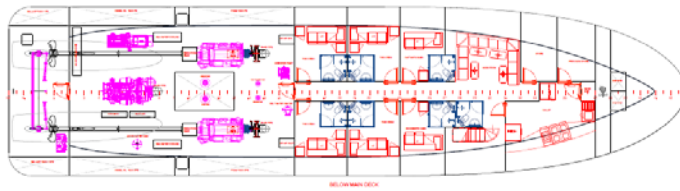
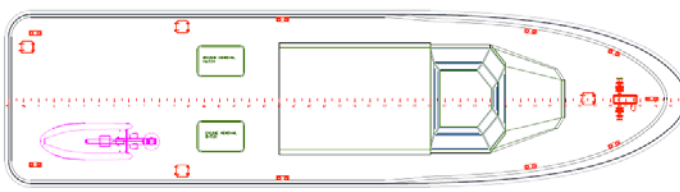
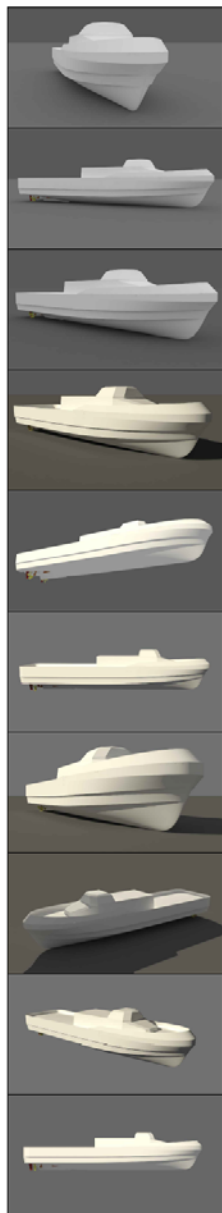
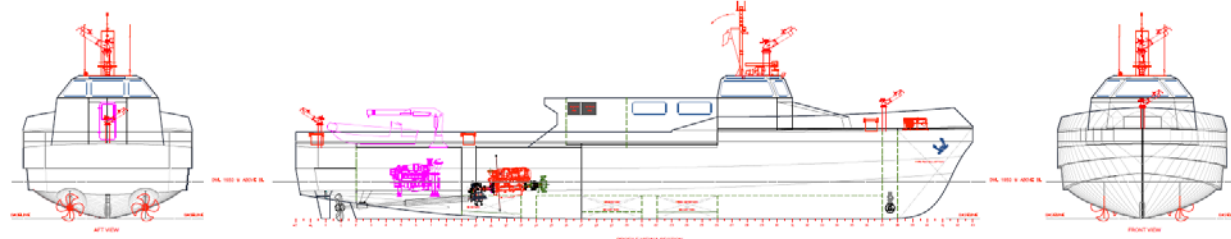

CLASS NOTATION

RC1 (VESSEL) (M3/H)
 Deck Machinery (M3/H)

MAIN DIMENSIONS

LOA (Length over all) m 36.00
 LWL (Length water line) m 30.00
 DFL (Length Deck Length) m 30.00
 B (Beam maximum) m 6.00
 D (Depth maximum) m 3.00
 D (Depth) m 3.00
 D (Depth) m 3.00
 D (Depth) m 3.00

SPEED POWER PROPULSION AUX MACHINERY

Cruising Speed (knots) 12.00
 Max. Speed (knots) 17.00
 Max. Thrust (kW) 1700
 Max. Thrust (HP) 2300
 Max. Thrust (kW) 1700
 Max. Thrust (HP) 2300

TANK CAPACITY

Speed (knots) 12.00
 Max. Thrust (kW) 1700
 Max. Thrust (HP) 2300
 Max. Thrust (kW) 1700
 Max. Thrust (HP) 2300

TONNAGE INFORMATION

Net Tonnage 200.00
 Gross Tonnage 200.00
 Net Tonnage 200.00
 Gross Tonnage 200.00

FIRE FIGHTING SYSTEM

No. Pump No. 1 1000L/min
 No. Pump No. 2 1000L/min
 No. Pump No. 3 1000L/min
 No. Pump No. 4 1000L/min
 No. Pump No. 5 1000L/min
 No. Pump No. 6 1000L/min

NO.	DATE	REVISION	REV.	BY
VESSEL NAME: 36 M FIRE FIGHTING BOAT				
TITLE: PRELIMINARY GA PLAN				
DESIGNER				
BUILDER				
CLASS				
VOLMARINE		www.volmarine.com		
SHIP TECHNOLOGIES		e-mail: volkan@volmarine.com		
3D CAD - CIVIL - ARCH - CONSTRUCTION - ANALYSIS		https://www.facebook.com/Volmarine-Ship-Technologies-Gemi-Dizayn-Ofisi-657455656725252/		
Drawn by	Checked by	CONTROLLED BY	SCALE	DRAWING NO.
DESIGNED BY	DESIGNED BY	DESIGNED BY	1:100	30FFB
				DL

15M CATAMARAN FISH FARM FEEDER BOAT - TYPE: 01



15M CATAMARAN FISH FARM FEEDER BOAT - TYPE: 02

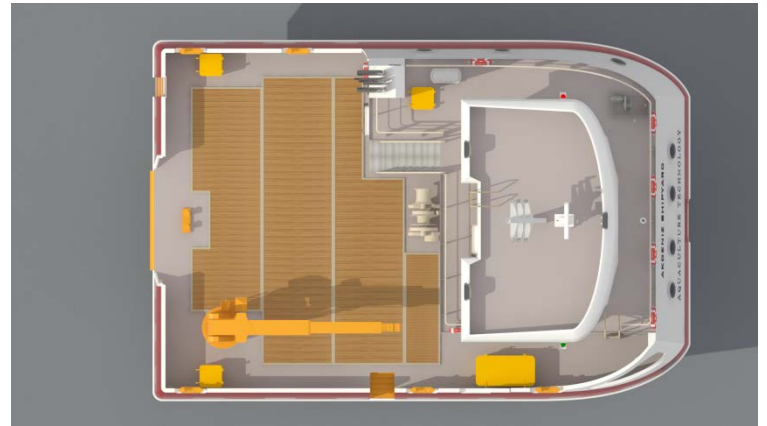

15M CATAMARAN FISH FARM FEEDER BOAT - TYPE: 02

GENERAL ARRANGEMENT PLAN

15M CATAMARAN AQUACULTURE SERVICE BOAT GENERAL ARRANGEMENT PLAN

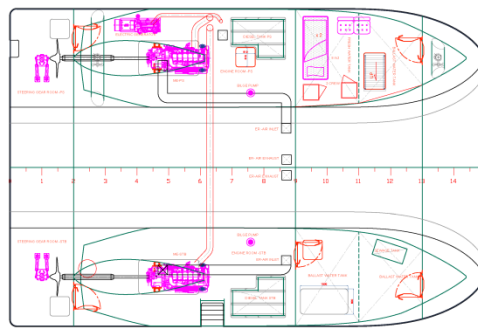
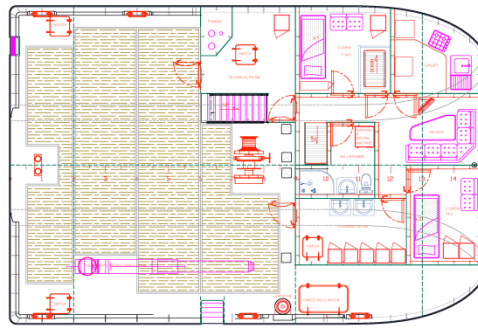
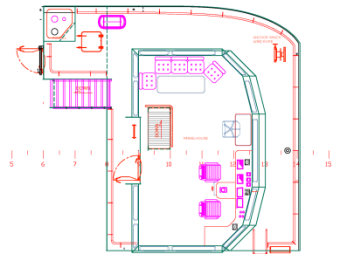
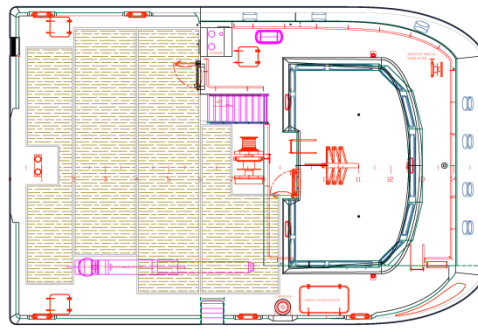
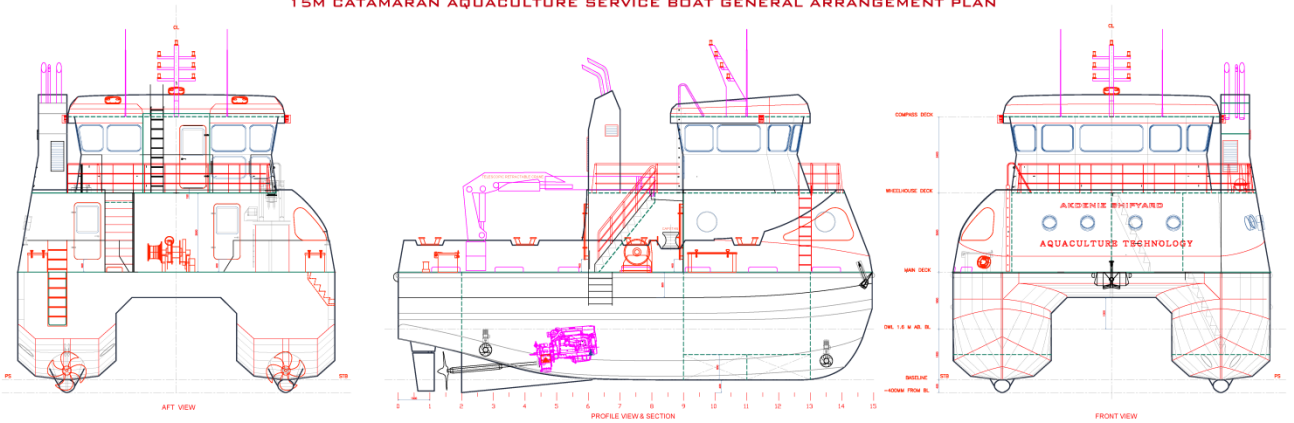

MAIN DIMENSIONS

LOA (Overall Deck)	14.90
LOA (Length Water Line)	14.74
LOA (Length Between Perpendiculars)	10.74
Beam (width max deck)	5.00
Beam (width max hull)	3.90
T (Deck Height)	1.80
DB (Deck Coefficient (for Deck Hatch))	0.85
Flare (Square)	3900 mm
Stair (Capacity)	3.00 ton
Building Material	FRP - Fiberglass Reinforced Plastic

SPEED POWER PROULSION AUX MACHINERY

Service Speed (km/h)	33 knots @ Full Load Condition
Max Speed (km/h)	33 knots @ Low Load Condition
Max Engine	2x 800HP - Intermediate @ 2000RPM
Reduction Gear	2x Planer (1:0.85)
Propeller Diameter	2x 600mm - Diameter (100mm - 1400mm dia)
Shaft & Stern Flange	2x 80mm
Shaft Coupling	2x 200mm

TANK CAPACITIES

Dead Stow	8.40
Fresh Water	4.80
Seawater	1.80
Ballast	4.80

TORNADE INFORMATION

Lighting	150 Watt
Maximum Storage @ 1 Max	800 kg
Deck @ 1 Max	35 ton

DECK MACHINERY

Deck	3x 3mm AluDeck
Deck	3x 50mm

NO.	DATE	REVISION	BY

15 M CATAMARAN FISH FARM SERVICE BOAT

PRELIMINARY GA PLAN

OWNER: AKSENIS SHIPYARD
 BUILDER: AKSENIS SHIPYARD
 DESIGNED BY: [Signature]
 APPROVED BY: [Signature]

SCALE: DRAWING NO: 15M-FSB-GA-00

15M CATAMARAN FISH FARM FEEDER BOAT - TYPE: 03

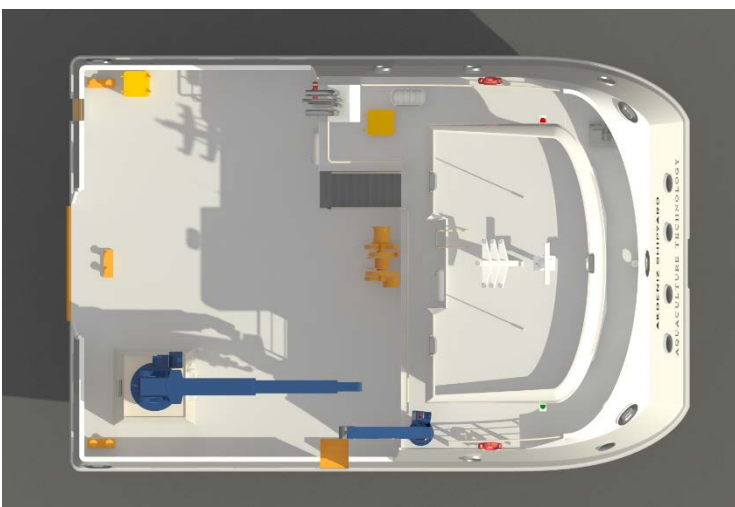
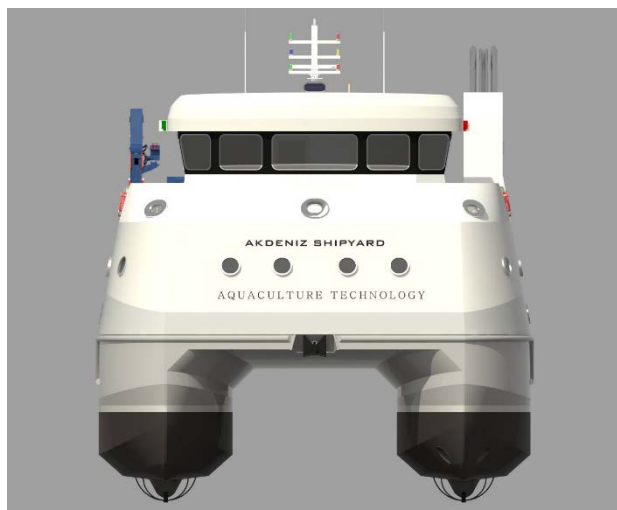

20M SHRIMP TRAWLER

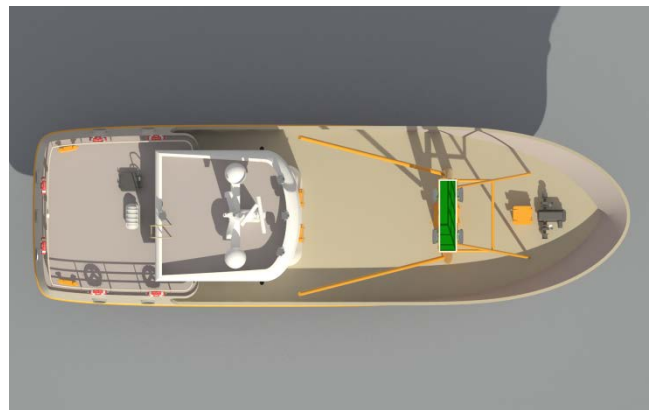

20M SHRIMP TRAWLER GENERAL ARRANGEMENT PLAN

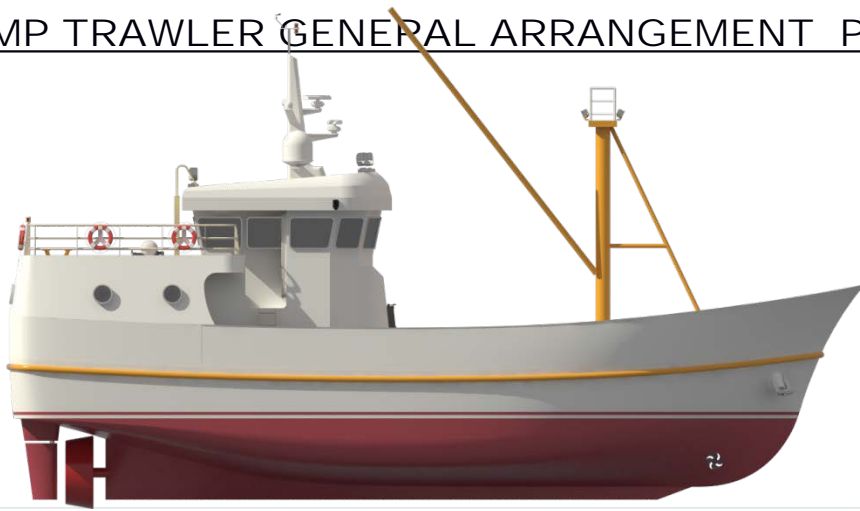

20M SHRIMP TRAWLER GENERAL ARRANGEMENT PLAN

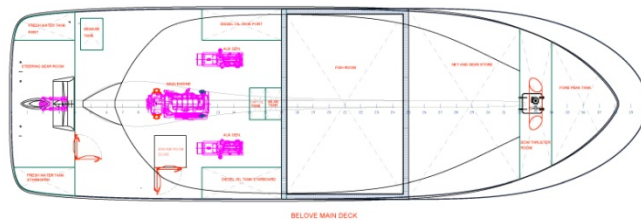
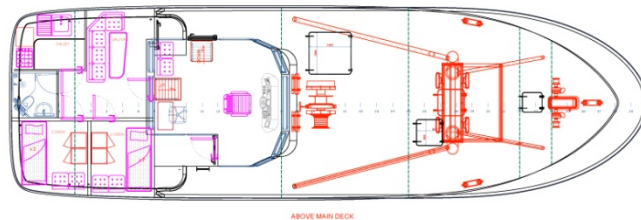
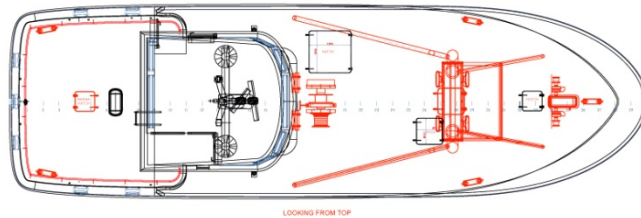
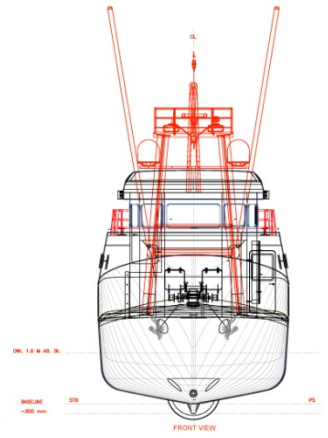
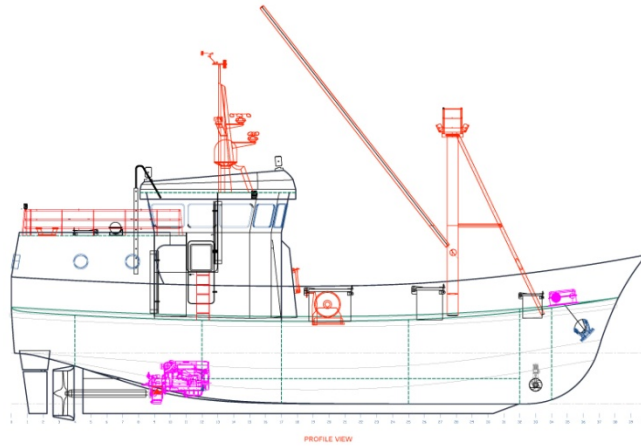
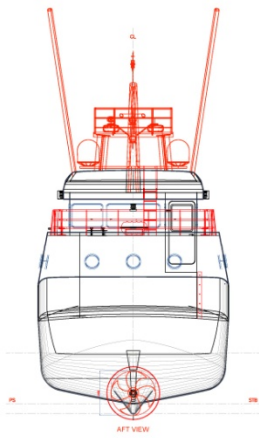

MAIN DIMENSIONS:

LOA (Length Overall)	20.00
LOA (Length Between Perpendiculars)	18.00
B (Beam)	3.00
D (Depth)	1.80
T (Trough)	1.80
Stowage Deck Height	1.80
Deck Height	1.80
Keel Depth	1.80
Keel Clearance	1.80
Keel Structure	4-Stroke Marine Diesel

SPEED, POWER, PROPULSION, AUXILIARY MACHINERY:

Service Speed (knots)	10.00
Max Speed (knots)	12.00
Propeller Diameter	1.80
Shaft Power	150 HP
Shaft Diameter	1.80

TANK CAPACITIES:

Oil	1000
Water	1000
Waste	1000
Other	1000
Other	1000
Other	1000

NO.		DATE		REVISED		YES		NO	
20 M SHRIMP TRAWLER									
PRELIMINARY GA PLAN									
VOLMARINE									
DESIGNED BY: [Name]					SCALE: 1:50				
30M-ST-GA-00									

24M CREW BOAT

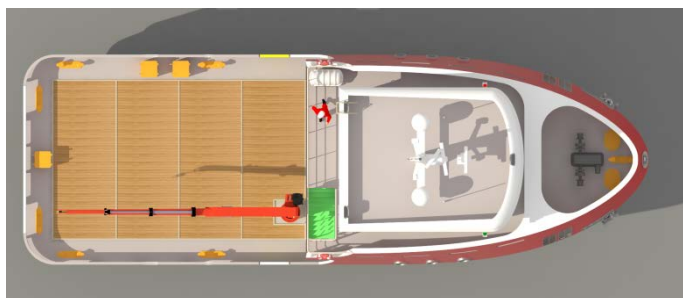

LOA:38M / 520 M3 CARGO CAPACITY OIL TANKER

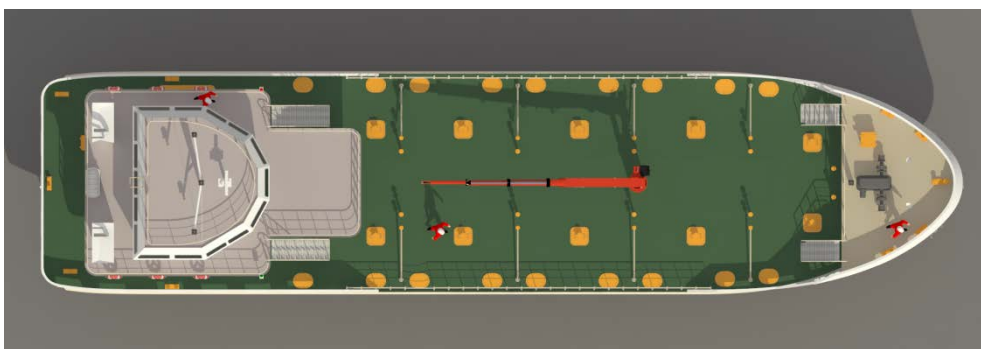
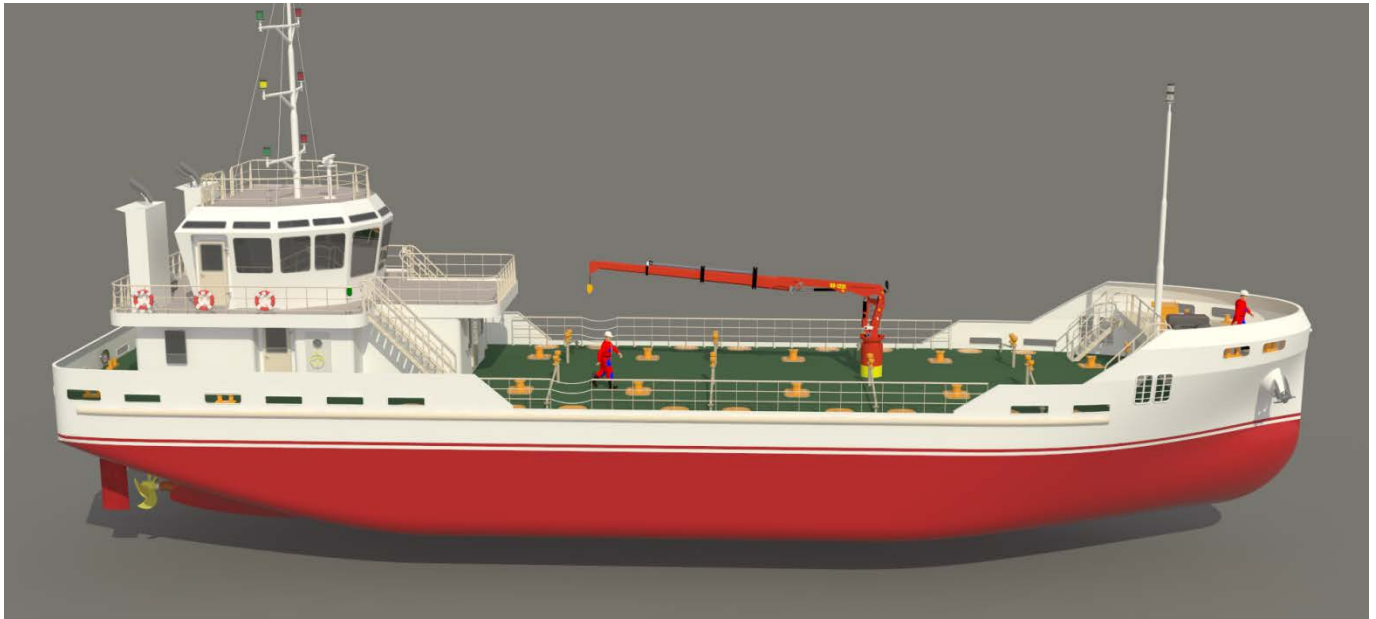

LOA:38M / 520 M3 CARGO CAPACITY OIL TANKER GA PLAN

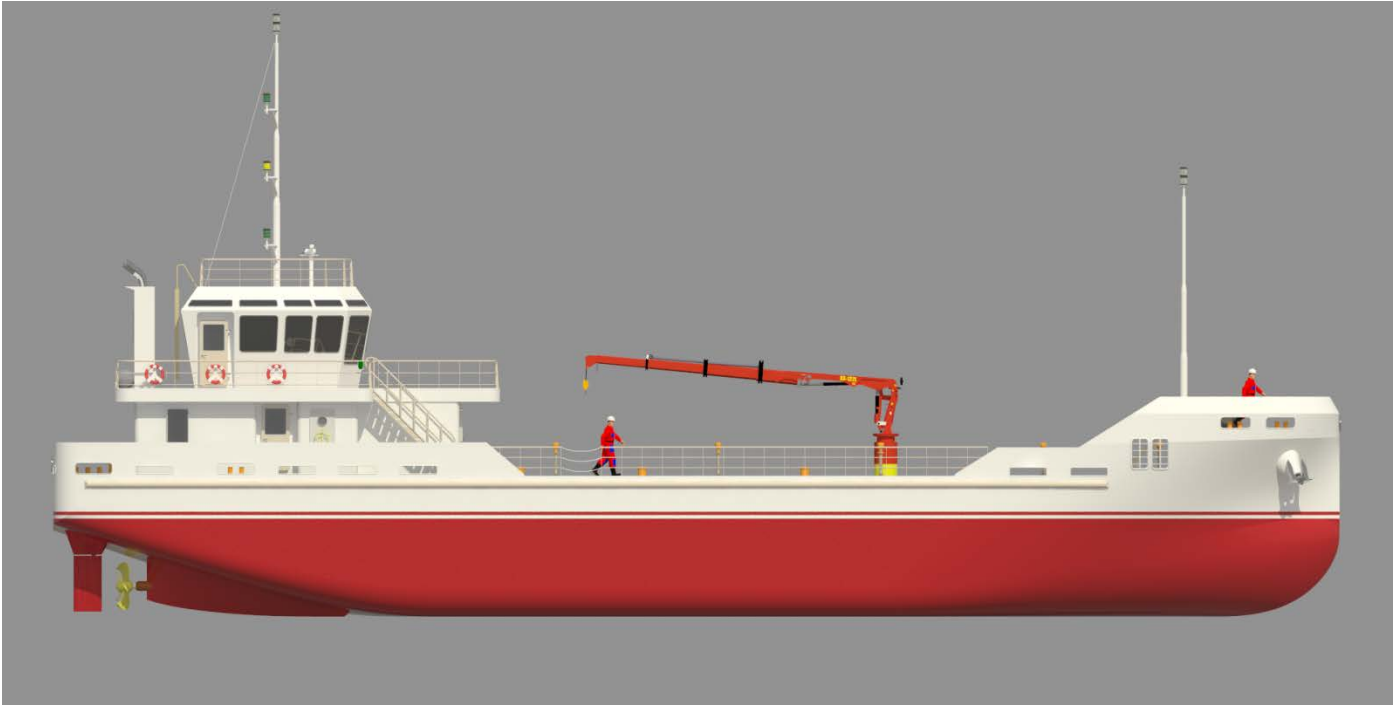

500 M3 CAPACITY OIL TANKER GENERAL ARRANGEMENT PLAN

APPROXIMATE DATA

Length	38.00
Beam	7.50
Depth	3.50
Displacement	520 M3
Speed	12.00
Consumption	15.00
Power	1500
Capacity	500 M3

GENERAL ARRANGEMENT PLAN

NO.	1	NAME	500 M3 OIL TANKER
DATE	2023	SCALE	1:100
DESIGNER	VOLMARINE		
CLIENT	[Client Name]		
PROJECT	[Project Name]		
STATUS	[Status]		
REVISIONS	[Revisions]		



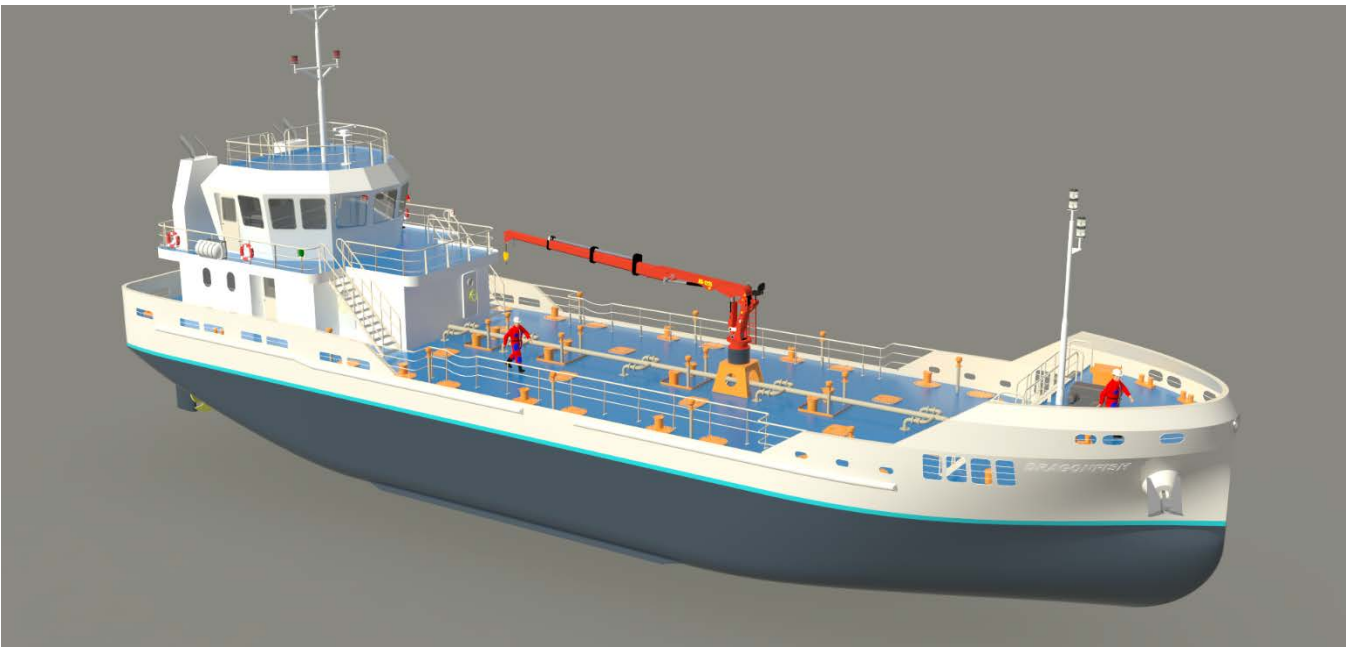
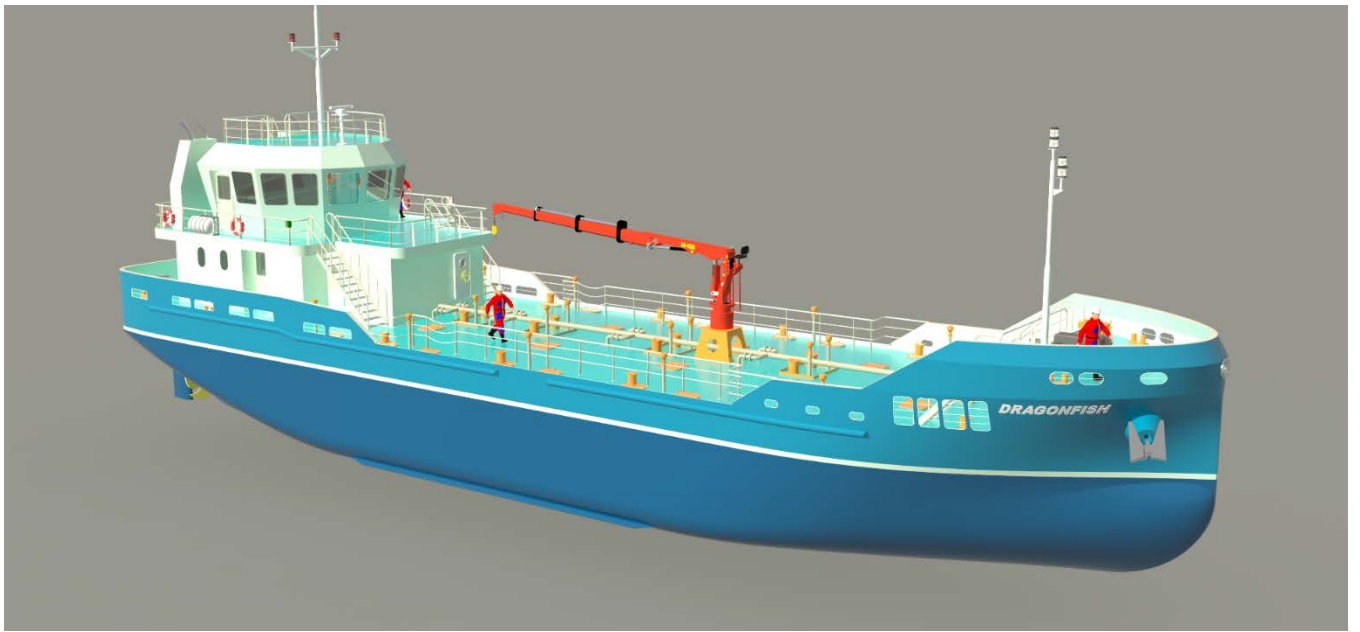

LOA:24M FISHING VESSEL VERSIYON: 1



LOA:24M FISHING VESSEL VERSIYON: 2



LOA:24M FISHING VESSEL VERSIYON: 3



PILOT BOAT LOA:15M



BILGE TANKER 260M3



BILGE TANKER 240M3



FISHING-BOAT-11M- V1



FISHING-BOAT-11M- V2



FISHING-BOAT-11M-V3



MOORING-BOAT-12M-V1



700M3 - 499 GRT TANKER - V1

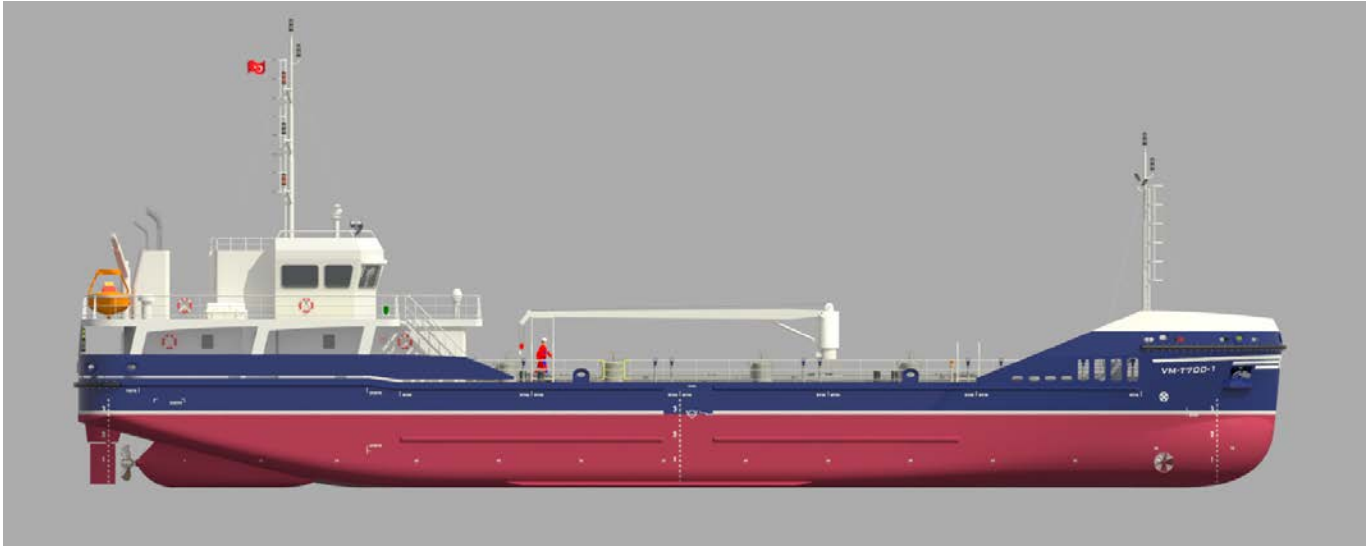

720M3 – 499 GRT TANKER – V2

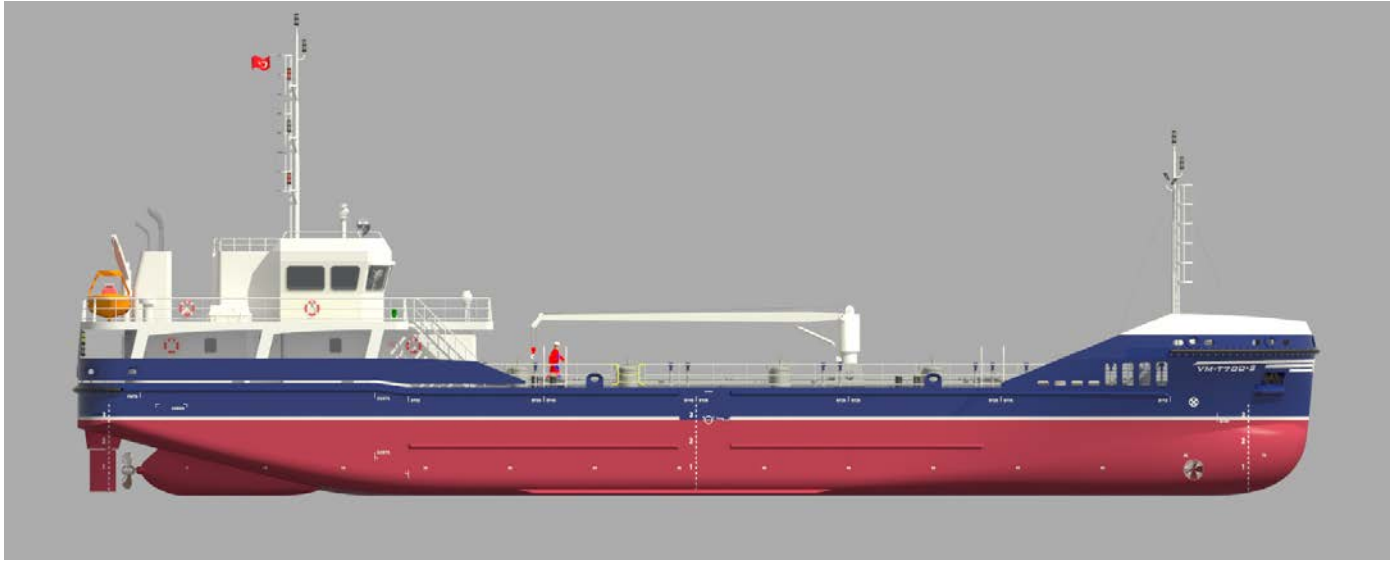

110M - INLAND TANKER TYPE C - V1

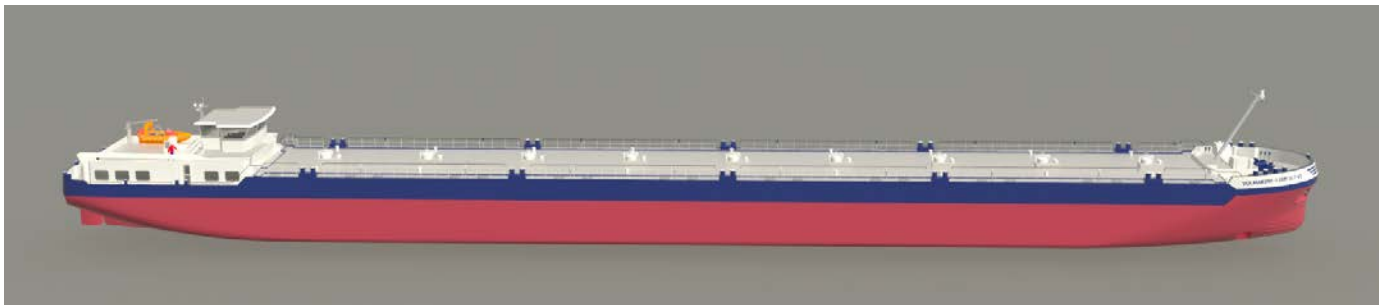

INTACT & DAMAGED STABILITY CALCULATIONS:

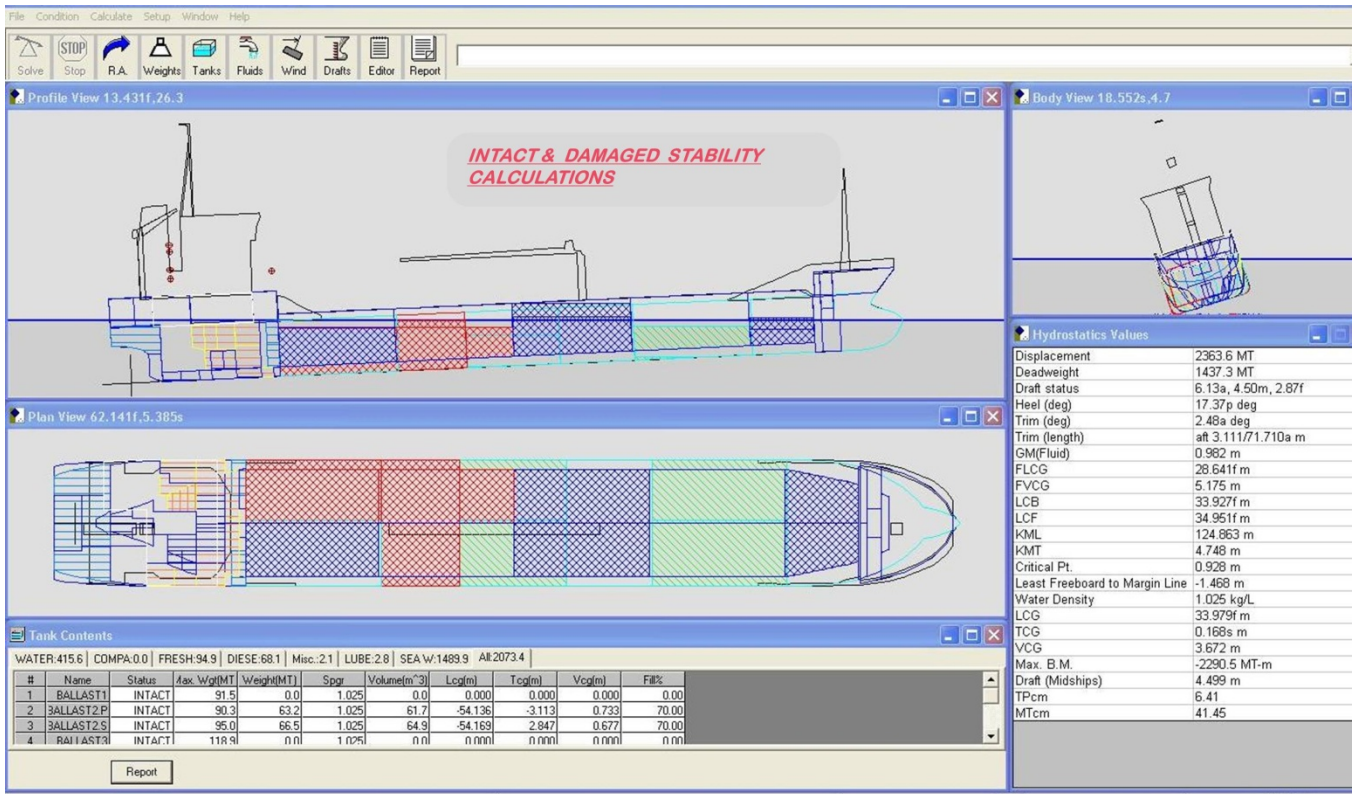

SPEED-POWER-RESISTANCE PREDICTIONS:

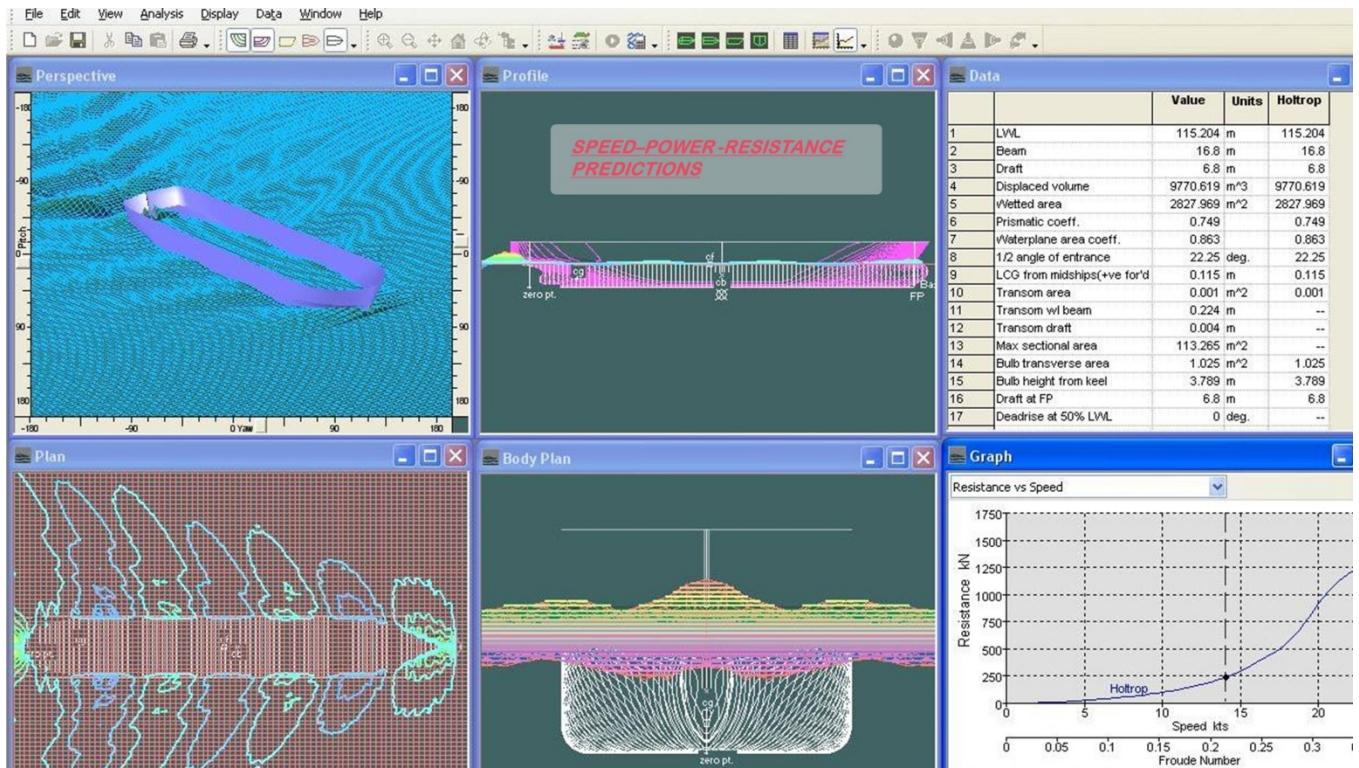

STRUCTURAL CALCULATIONS - CLASS DRAWINGS

WORKSHOP DRAWINGS - NESTING WORKS

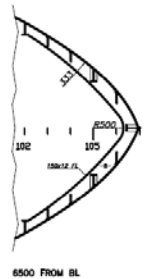
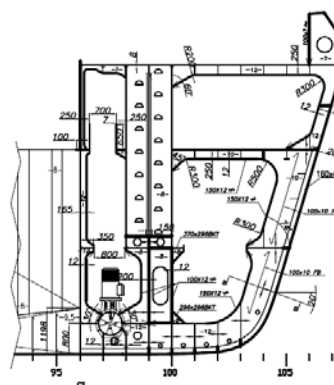
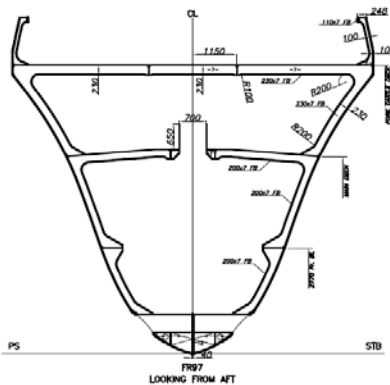
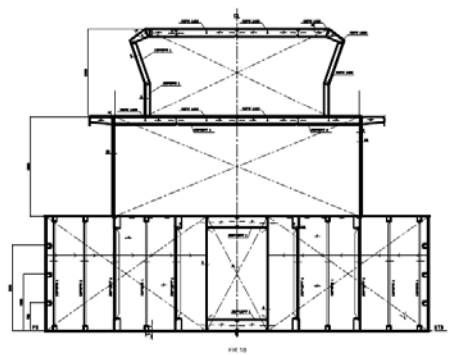
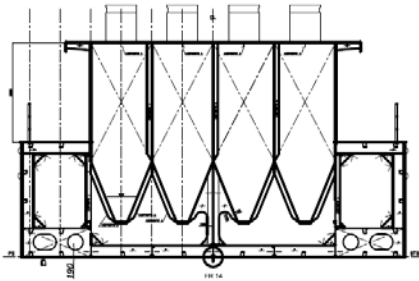
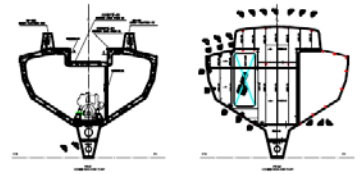
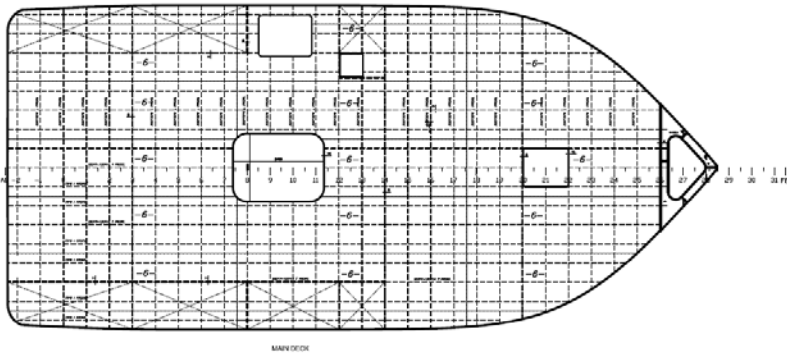
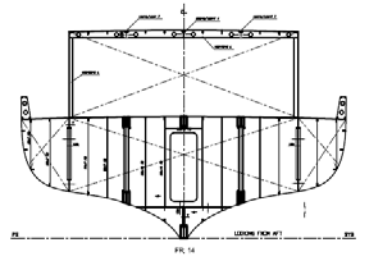
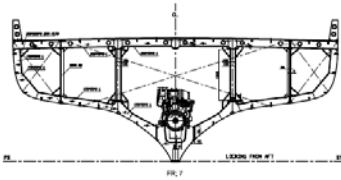
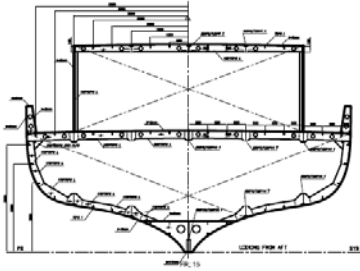
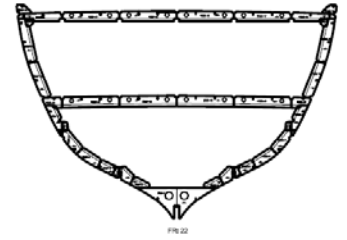
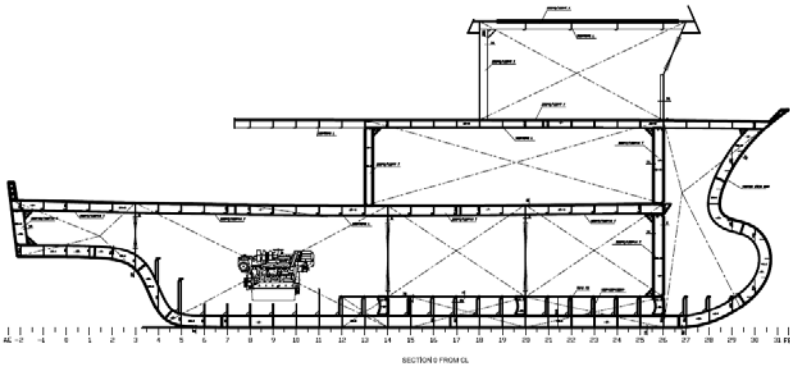

VOLMARINE
SHIP TECHNOLOGIES

DESIGN CONSULTANCY CONSTRUCTION MACHINERY

VOLMARINE SHIP TECHNOLOGIES
VOLMARINE GEMİ TEKNOLOJİLERİ MÜHENDSLİK LİMİTED ŞİRKETİ

Web : www.vol-marine.com

E-mail : volkan@vol-marine.com

E-mail : info@vol-marine.com

Tel : +90 536 377 32 33

www.facebook.com/Volmarine-Ship-Technologies-Gemi-Dizayn-Ofisi-967455656725262/

Contact Person: Volkan Esatoglu

Adress:

VARYAP PLAZA PENDİK

ESENYALI MAHALLESİ , UYGAR SOKAK, NO:61, OFİS NO:74

PENDİK / İSTANBUL / TÜRKİYE